

Note: Some designs in this collection may have been created using unique special stitches and/or techniques. To preserve design integrity when rescaling or rotating designs in your software, always rescale or rotate designs using the handles directly on-screen.



19999-022 In the Hoop Ninja Pouch

4.06 X 5.51 in.
103.12 X 139.95 mm
2,579 St. **L**

Listings below indicate color sample, stitching order and suggested thread color number. "I" refers to Isacord thread and "T" refers to Timeless thread. Colors beginning with 20501 refer to YLI Fine Metallics, 7 refer to Yenmet Metallic, 8 refer to YLI Variations Variegated Thread and 9 refer to Isacord Multicolor Variegated.

	I	T
19999-022 In the Hoop Ninja Pouch		
■ 1. Reverse Appliqué Eye Placement Stitch.....	0020	28151
■ 2. Reverse Appliqué Tackdown.....	0020	28151
■ 3. Zipper Placement Stitch.....	0020	28151
■ 4. Zipper Tackdown.....	0020	28151
■ 5. Front Panel Tackdown.....	0020	28151
■ 6. Reverse Appliqué Cut Guide.....	0020	28151
■ 7. Eyes.....	0020	28151
■ 8. Mouth & Nose.....	0020	28151
■ 9. Seam Stitch.....	0020	28151

⌘ Design contains a loose fill.

⚙ Some solid areas shown are not stitched.

L Design is larger than 5" (127 mm) in either direction.

S Design is smaller than 1.5" (38.1 mm) in either direction.

Create a ninja shaped reverse appliqué zippered pouch in the hoop of your embroidery machine. Use black fabric for the main pouch, tan fabric for the skin, and a red zipper and bias tape for a boy. Change out the colors of fabric and zipper to pink for a girl. It is a quick and fun in the hoop project. The kids will love them!

Supplies

- OESD Embroidery Design In the Hoop Ninja Pouch
- Medium tear away stabilizer
- ¼ yd. black fabric (pouch) (boy ninja) OR ¼ yd. pink fabric (pouch) (girl ninja)
- 1 ½" x 3 ½" piece tan fabric (skin)
- 7" red zipper (boy ninja) or 7" pink zipper (girl ninja)
- Red bias tape (boy ninja) OR pink bias tape (girl ninja)
- Embroidery threads
- Temporary spray adhesive



Cut

- (1) 4" x 5" piece black OR pink fabric (fold in half to measure 2" x 5") (head top)
- (1) 10" x 5" piece black OR pink fabric (fold in half to measure 5" x 5") (face)
- (1) 14" x 5" piece black OR pink fabric (fold in half to measure 7" x 5") (back)
- (1) 8" piece red OR pink bias tape

Instructions

- Hoop tear away stabilizer.
- Stitch the first stitch of embroidery design which is the Reverse Appliqué Eye Placement Stitch. **Photo 1**
- Center and place the skin fabric over the placement stitch.
- Stitch the second stitch of the embroidery design called Reverse Appliqué Tackdown. Trim the fabric. **Photo 2**
- Stitch the third stitch of the embroidery design called Zipper Placement Stitch. **Photo 3**
- Using temporary spray adhesive, spray the zipper placement stitch. Center and place zipper over the stitching lines. Stitch the fourth stitch of embroidery design called Zipper Tackdown. **Photo 4**
- Fold the head top and face fabric pieces in half, with wrong sides together and press, as indicated in the above Cut section.
- Center and place head top fabric with folded edge to top teeth of zipper, leaving at least a ¼" on either end. Center and place face fabric with folded edge to bottom teeth of zipper, leaving at least a ¼" on either end.
- Stitch the next stitch of the embroidery design called Front Panel Tackdowns. This will stitch head top and face fabric sections in place. **Photo 5**
- Stitch the next stitch called Reverse Appliqué Cut Guide. **Photo 6**

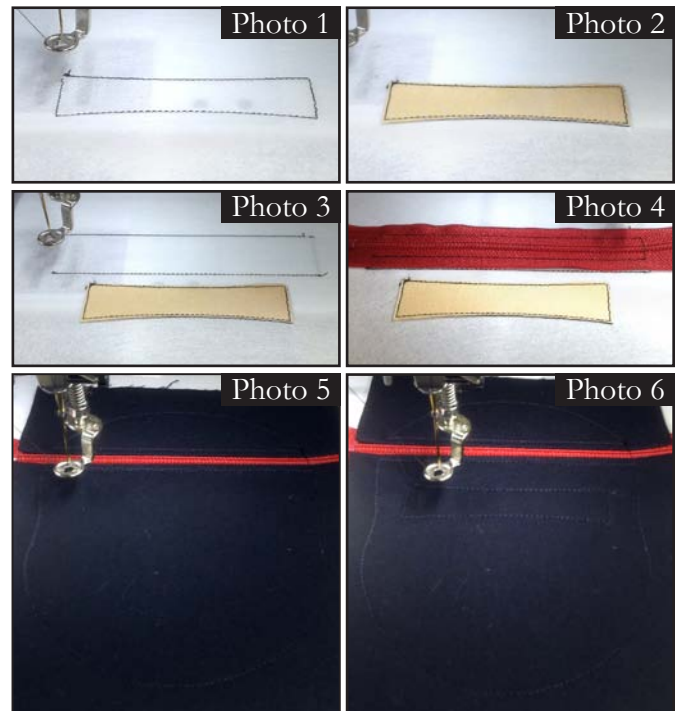

- Next, you will trim inside the Reverse Appliqué Cut Guide stitching, being careful not to cut into the skin fabric. This will show the skin fabric for the stitching of the eyes. **Photo 7**
- Stitch the Eyes, Mouth and Nose, then unzip the zipper halfway. **Photo 8**
- Fold bias tape in half and place over the middle of zipper on the right side, keeping the bias tape out of the seam. Right sides together, place back fabric over design, making sure to cover the entire design. Stitch the final stitch called Seam Stitch. **Photo 9**
- Remove the pouch from the hoop and trim excess stabilizer and fabric. Trim the stabilizer from the zipper. Turn right side out and press.
- Tie the bias tape in a knot. Cut the ends at an angle.
- Have fun making In the Hoop Ninja Pouches in black for a boy or pink for a girl!



Photo 7



Photo 8



Photo 9

