



#51323
1 DESIGN/18 Files
PROJECT INSTRUCTIONS INCLUDED

FREESTANDING *Gingerbread Windmill*



It is a violation of Copyright law to make and distribute copies of electronic designs or artwork.
Electronic designs are licensed to the original purchaser for use at one location. ©2023 OESD, LLC. All rights reserved.

MATERIALS



Isacord Thread Colors

0015 White (2 Spools)
1141 Tan
1900 Geranium
2530 Rose
4430 Island Waters

Note: One spool of 1000 meter thread is adequate for the project unless otherwise noted.

MATERIALS



Stabilizers

- OESD AquaMesh WashAway
- OESD BadgeMaster WashAway
- OESD StabilStick CutAway
- OESD Applique Fuse and Fix
- OESD Fiber Form

Fabrics/Textiles

- Brown quilter's cotton 1/4 yard
- Red OESD Luxe Sparkle Vinyl
- White OESD Luxe Sparkle Vinyl
- Note: Fabric sizes are estimates and may result in overage.

Notion & Tools

- OESD Alligator Clamps
- OESD Button Clips
- OESD Expert Embroidery Tape TearAway
- OESD Expert Embroidery Tape WashAway
- OESD Perfect Punch Tool
- OESD Perfect Embroidery Press Cloth
- OESD Grippy GRID
- 1/4" Dowel cut to 5" long
- Embroidery Needle Sharp 75/11 (FSA)
- Embroidery Needle Ballpoint 80/12 (FSL)

Isacord Thread Colors

- Per thread chart
- Match the bobbin thread to the upper thread.

SUMMARY



Finished project size: Size 9" H x 5 1/2" W x 5 1/2" D

Bottom Side Wall 1
FSA
51323-01



Bottom Front Wall
FSA
51323-02



Bottom Side Wall 2
FSA
51323-03



Bottom Back Wall FSA
51323-04



Front Door Walls
FSA
51323-05



Requires 1 Design
Front Door Roof
FSA
51323-06



Requires 1 Design
Front Door Snow
FSL
51323-07



Requires 1 Design
Top Side Wall 1
FSA
51323-08



Requires 1 Design
Top Front Wall
FSA
51323-09



Requires 1 Design
Top Side Wall 2
FSA
51323-10



Requires 1 Design
Top Back Wall
FSA
51323-11



Requires 1 Design
Roof FSA
51323-12

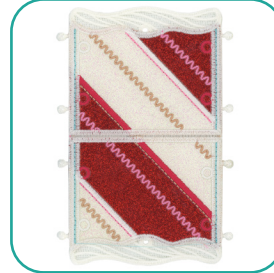

Requires 1 Design
Roof Snow FSL
51323-13

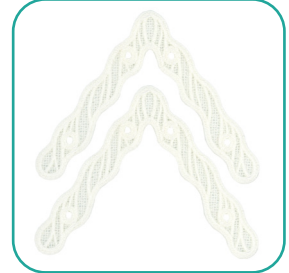

Requires 1 Design
Platform FSA
51323-14

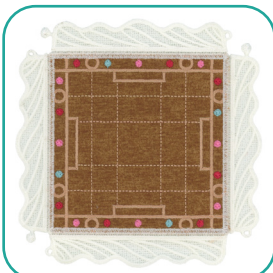

Requires 1 Design
Back Blades Holder FSL
51323-15



Requires 1 Design
Blades FSA
51323-16



Requires 1 Design
Front Blades Holder FSA
51323-17



Requires 1 Design
Foundation FSA
51323-18

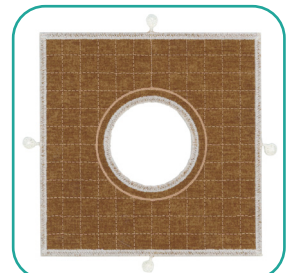

Requires 1 Design

Requires 1 Design

Requires 1 Design

Requires 1 Design

Requires 1 Design

It is a violation of Copyright law to make and distribute copies of electronic designs or artwork.

Electronic designs are licensed to the original purchaser for use at one location. ©2023 OESD, LLC. All rights reserved.

EMBROIDERY

General Instructions

The freestanding applique instructions, included in the collection, are general instructions. For demonstration purposes, a sample design that best demonstrates the technique is shown. Fabric and thread requirements will vary by design, but the general technique is the same. All designs are stitched with matching thread, top and bobbin.

Note: Some thread colors in instructions have been changed or digitally enhanced for better visibility.

Step 1

- Print the mirrored version of the templates (at 100% scale or 1:1 ratio) onto the paper side of Applique Fuse and Fix.
- Cut approximately 1/4"-1/2" outside the printed applique templates.

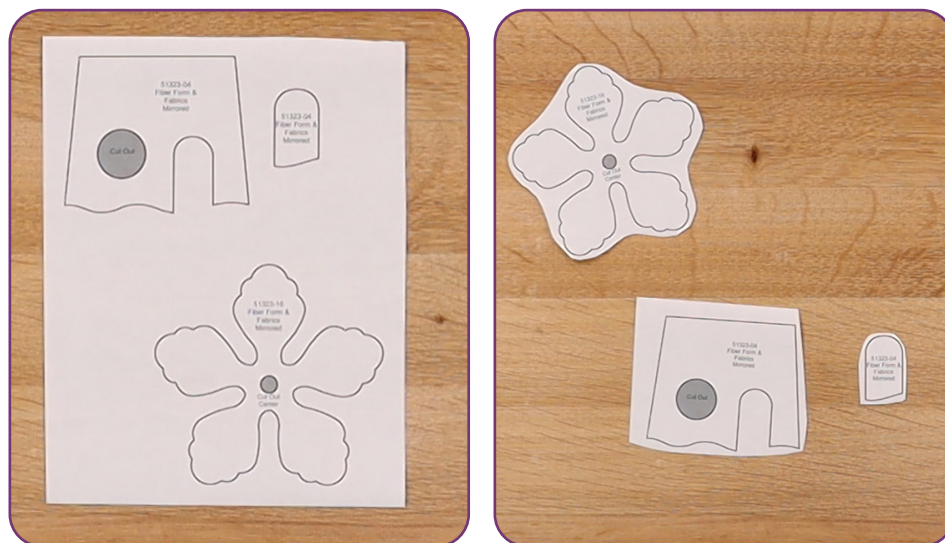

EMBROIDERY

Step 2

- Cut the Fiber Form 1/4"-1/2" larger than the applique templates.
- Fuse the trimmed templates to the back of the Fiber Form with the paper side of the printed template up. Hold the iron on the template for 10-15 seconds for a secure fuse.

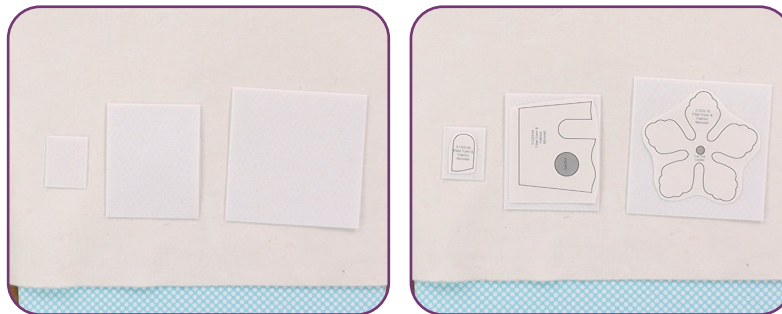

Step 3

- Trim the Fiber Form on the edge of the black outline.
- Set aside.



Step 4

- Adhere one layer of StabilStick CutAway to the wrong side of all applique fabrics, including the Luxe Sparkle Vinyl, to provide stiffness to the finished structure.
- Cut the prepared applique fabrics 1/4"-1/2" larger than the templates that are included at the end of the instructions.

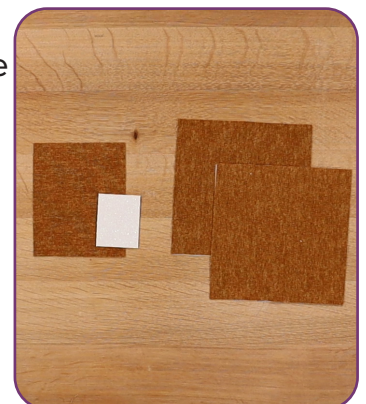

EMBROIDERY

□ Step 5

- Hoop one layer of AquaMesh and one layer of BadgeMaster for all designs.

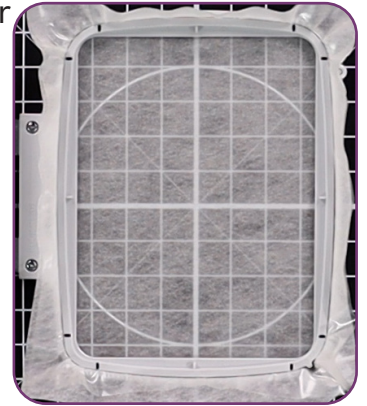

□ Step 6

- Load selected design into the machine.
- Example design is 51323-04.
- Thread the machine per the thread chart.
- Place hoop on the machine.
- Stitch Machine Step 1, Fiber Form and Brown Fabric Placement Stitch.

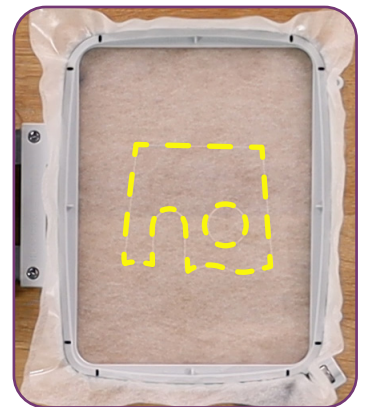

□ Step 7

- Remove the hoop from the machine, but NOT the project from the hoop.
- Lay the hoop on a flat surface.
- On the back of the Fiber Form, score and remove the paper backing to reveal the adhesive surface.
- Place the Fiber Form within the placement stitching.
- Finger press to secure.

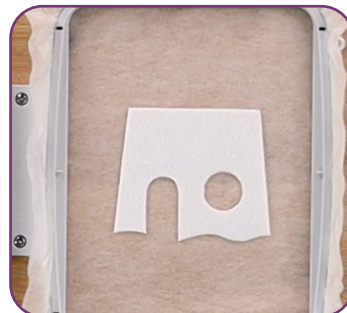

EMBROIDERY

□ Step 8

- Completely cover the Fiber Form and the placement stitch with the prepared applique fabric.
- Tape in place to secure.

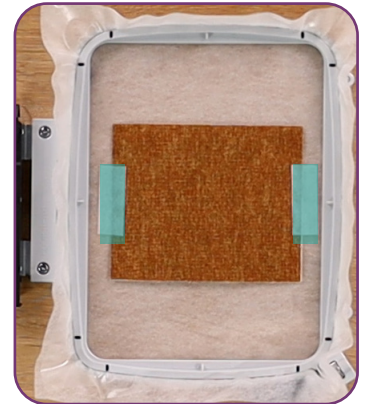

□ Step 9

- Return the hoop to the machine.
- Stitch Machine Step 2, Cut Line and Tackdown.

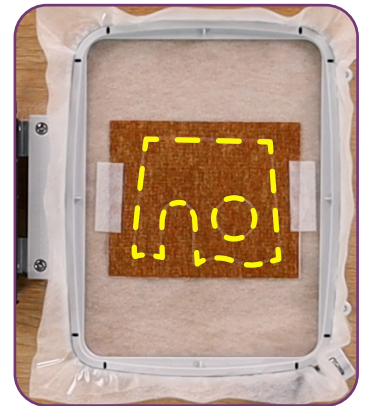

□ Step 10

- Remove the hoop from the machine, but NOT the project from the hoop.
- Trim the excess fabric as close to the cut line as possible. If the outermost stitches (cut line) are cut, the inner stitches (tackdown) will hold the applique in place.
Tip: If the stabilizer is cut or a hole is created while trimming the fabric, use OESD Expert Embroidery Tape WashAway as a patch.

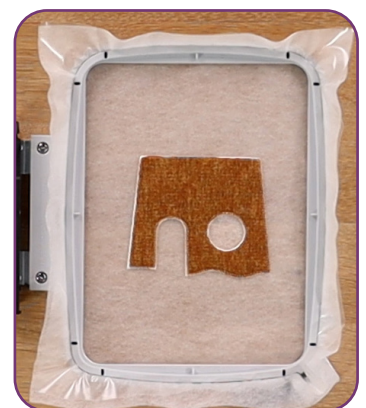

EMBROIDERY

□ Step 11

- Return the hoop to the machine.
- Stitch Machine Step 3, White Vinyl Placement Stitch.

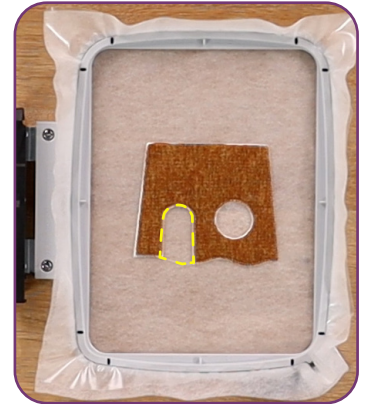

□ Step 12

- Remove the hoop from the machine, but NOT the project from the hoop.
- Lay the hoop on a flat surface.
- On the back of the Fiber Form, score and remove the paper backing to reveal the adhesive surface.
- Place the Fiber Form within the placement stitching.
- Finger press to secure.

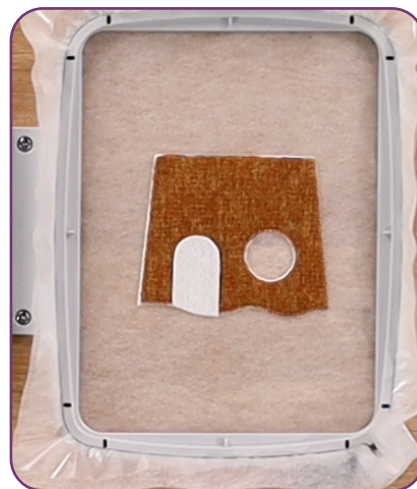

EMBROIDERY

□ Step 13

- Completely cover the Fiber Form and the placement stitch with the prepared Luxe Sparkle Vinyl.
- Tape in place to secure.



□ Step 14

- Return the hoop to the machine.
- Stitch Machine Step 4, Cut Line and Tackdown.

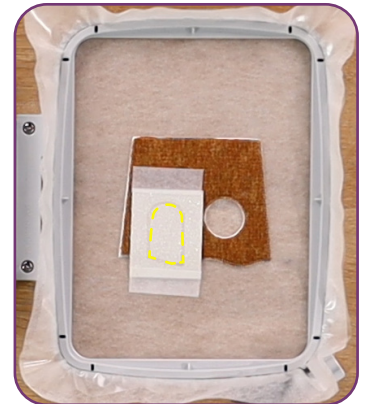

□ Step 15

- Remove the hoop from the machine, but NOT the project from the hoop.
- Trim the excess vinyl as close to the cut line as possible.



EMBROIDERY

□ Step 16

- Return the hoop to the machine.
- Stitch the remaining machine steps per the thread with matching bobbin thread.



□ Step 17

- When the design is complete, remove the project from the hoop and trim the stabilizer 1/4" - 1/2" outside the design.



EMBROIDERY - DOUBLE SIDED APPLIQUE



Design: 51323-16

□ Step 18

- Hoop one layer of AquaMesh and one layer of BadgeMaster for all designs.

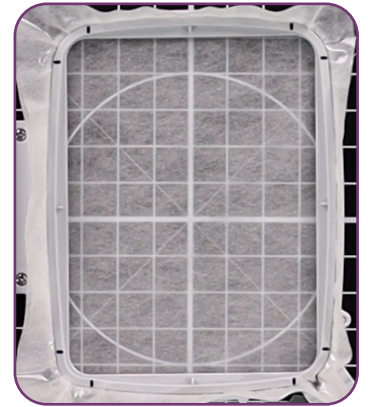

□ Step 19

- Load selected design into the machine.
- Example design is 51323-16.
- Thread the machine per the thread chart.
- Match the bobbin thread to the upper thread throughout.
- Stitch Machine Step 1, Fiber Form/Front Brown Fabric Placement Stitch.

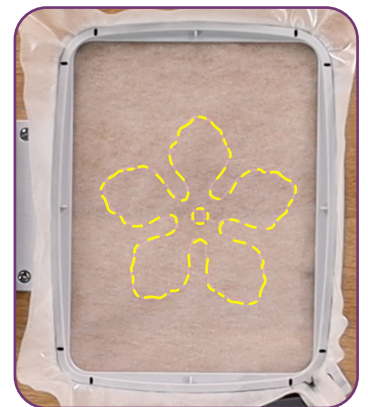

EMBROIDERY - DOUBLE SIDED APPLIQUE



□ Step 20

- Remove the hoop from the machine, but NOT the project from the hoop.
- Place the hoop on a flat surface.
- On the back of the Fiber Form, score and remove the paper backing to reveal the adhesive surface.
- Place the Fiber Form within the placement stitching.
- Finger press to secure.

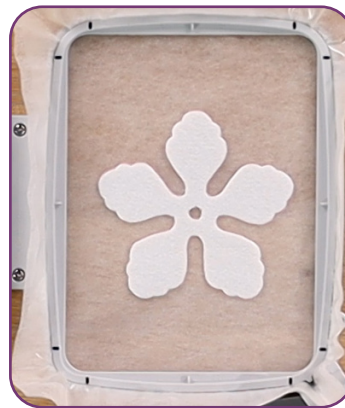

□ Step 21

- Completely cover the Fiber Form and the placement stitch with the prepared applique fabric.
- Tape in place to secure.

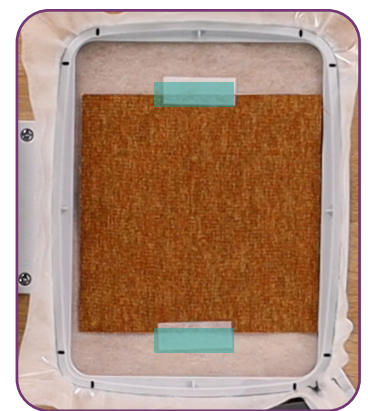

EMBROIDERY - DOUBLE SIDED APPLIQUE



□ Step 22

- Return the hoop to the machine.
- Stitch Machine Step 2, Cut Line and Tackdown.



□ Step 23

- Remove the hoop from the machine, but NOT the project from the hoop.
- Trim the excess fabric as close to the cut line as possible. If the outermost stitches (cut line) are cut, the inner stitches (tackdown) will hold the applique in place.
Tip: If the stabilizer is cut or a hole is created while trimming the fabric, use OESD Expert Embroidery Tape WashAway as a patch.

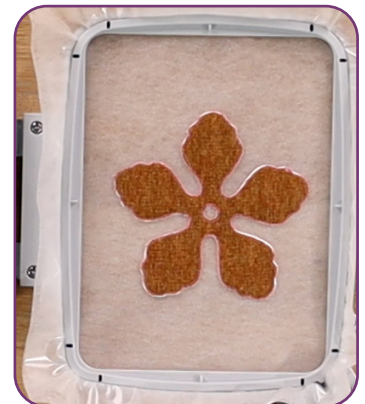

□ Step 24

- Return the hoop to the machine and stitch machine steps 3-5, per the thread chart.



EMBROIDERY - DOUBLE SIDED APPLIQUE



Step 25

- Remove the hoop from the machine, but NOT the project from the hoop.
- Turn the hoop over and place the prepared applique fabric, right side up, completely covering the design.
- Carefully tape to secure.
Tip: Avoid pushing too hard on the stabilizer to prevent it from dislodging from the hoop.

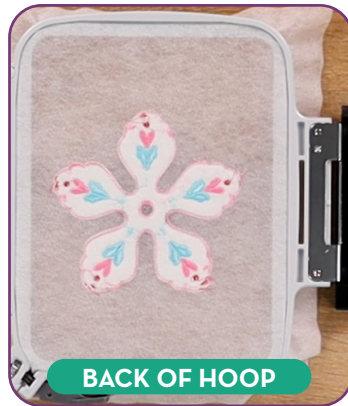

Step 26

- Return the hoop to the machine.
- Stitch Machine Step 6, Cut Line and Tackdown.



EMBROIDERY - DOUBLE SIDED APPLIQUE

□ Step 27

- Remove the hoop from the machine, but NOT the project from the hoop.
- Turn the hoop over and trim the excess fabric as close to the cut line as possible.



□ Step 28

- Return the hoop to the machine.
- Stitch the remaining machine steps per the thread with matching bobbin thread.



□ Step 29

- When the design is complete, remove the project from the hoop and trim the stabilizer 1/4" - 1/2" outside the design.



GENERAL FREESTANDING LACE GUIDE



Design:

51323-07, 51323-13, 51323-15

Stabilizer

- OESD AquaMesh
- OESD BadgeMaster

Notion/Tools

- 80/12 Embroidery Ballpoint Titanium needle for extended needle life
- OESD Alligator Clamps
- OESD Button Clips
- OESD Perfect Point and Press Tool

Isacord Thread Colors

- All OESD designs are digitized with Isacord 40 wt. polyester thread as the top thread and in the bobbin.
- Refer to the thread chart for color specifications.
- Match bobbin thread color to the top thread.

Instructions

Step 1 - Hoop

For FSL structures, hoop one layer of OESD AquaMesh and one layer of OESD BadgeMaster. BadgeMaster contains more starch so, combined with the AquaMesh, the lace is more rigid.

For other FSL, where a softer lace is desired, hoop two layers of AquaMesh.

Step 2 - Embroider

Stitch the design per the thread chart with matching thread in the bobbin at each color change.

When complete, remove from the hoop and trim away excess stabilizer about 1/4"-1/2" from the stitching.

Step 3 - Rinse

Rinse remaining stabilizer out in warm running water.

For stiffer lace and FSL structures, DO NOT rinse away all of the stabilizer. The lace should be just slightly tacky.

For softer lace, rinse until all traces of the stabilizer is removed.

Step 4 - Dry

Lay right side down flat on a non-stick surface, such as a cookie rack, parchment paper or Teflon sheet. This minimizes the tendency for the lace to curl.

Let the pieces dry completely before proceeding with any assembly.

Step 5 - Press

Once completely dry, press right side down on a OESD Perfect Embroidery Press Cloth.

Step 6 - Assemble Structure

Note: Specific assembly instructions for a design/collection may be found in the thread chart pdf following the individual design color charts.

Lace must be COMPLETELY DRY before assembly. Wetting the buttonettes or eyelets to assemble is not recommended and may result in them stretching and coming "unbuttoned" when dry.

Use a pair of OESD Alligator Clamps to insert the buttonettes into the eyelets. Insert the tip of the OESD Alligator Clamps into the eyelet, grasp the buttonette and pull through the eyelet. Alternatively, use a stiletto or tweezers to push the buttonette through the eyelet.

Helpful Tips

Limp Lace

If the design is not stiff enough, press the lace pieces on the wrong side while applying spray starch. After ironing, spray again with starch and allow to dry completely. This will stiffen the lace pieces nicely and aid in construction. Or easily re-stiffen by diluting some stabilizer scraps in water (or use liquid starch) and dipping the item in the solution. Lay flat to dry.

Eyelets Too Small

If any of the eyelets appear closed or too small to penetrate with Alligator Clamps, they may be stretched by inserting the small end of the OESD Perfect Point and Press Tool into the eyelet opening and stretching it open wide enough to accommodate the OESD Alligator Clamps.

Button Clips

During the assembly process, some structures pull on buttonettes that have already been inserted and could pull them out altogether. Putting a Button Clip on the assembled buttonette will keep it in position during the assembly process. Remove the Button Clips when the assembly is complete.

Alternative Construction Option

In some cases, the buttonettes may be pulled to the inside of a project, instead of being visible on the outside.

Insert the OESD Alligator Clamps through the eyelet from the wrong, or inside, of the lace and grasp the corresponding buttonette. Pull the buttonette to the wrong side of the lace.

Pulling the buttonettes to the inside may cause stress on the ones already done. Button clips may be placed on the completed buttonette(s) to prevent them from pulling out of the eyelet.

ASSEMBLY

□ Step 30

- Rinse each piece in warm running water until the design is only slightly tacky.
- Place right side down on a non-stick surface to dry. Parchment paper or a cooling rack work well to prevent curling. Dry completely.
- Once dry, press right side down on a Perfect Embroidery Press Cloth.



□ Step 31

- Before assembly, use a craft knife to cut through all the layers of the tab entries.
- Use the OESD Punch Tool with the 3mm attachment to create the eyelets indicated in the diagram.
Tip: Take care to not cut the satin stitching.
- Reference the Punch Tool Guide on page 27.

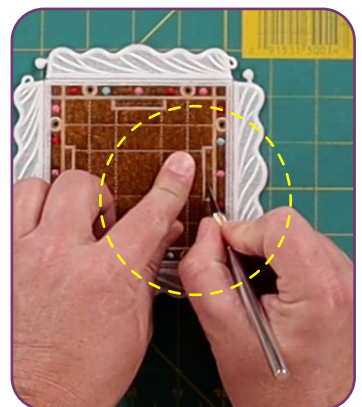

□ Step 32

- Line up the bottom wall pieces 51323-01, 51323-02, 51323-03, to connect.
- Thread the sewing machine with matching thread in the top and bobbin.
- Stitch together using a multi-step zigzag stitch (also known as a serpentine stitch).
- Back stitch at the beginning and end to secure.
- Trim thread tails.
- Fold and press into shape.



ASSEMBLY

□ Step 33

- Line up the top wall pieces 51323-08, 51323-09, 51323-10, to connect.
- Stitch together using a multi-step zigzag.
- Back stitch at the beginning and end to secure.
- Trim thread tails.
- Fold and press into shape.



□ Step 34

- Match the eyelets of the Front Door Roof FSA (51323-06) to Front Door Walls FSA (51323-05). Position the Front Door Roof FSA so the buttonettes are facing away from the locking tabs.
- Use Alligator Clamps to pull each buttonette through the corresponding eyelet, using button clips to temporarily hold them in place, as needed.



ASSEMBLY

□ Step 35

- Match the eyelets of the Front Door Snow FSL (51323-07) to the buttonettes of the Front Door Roof FSA (51323-06).
- Pull each buttonette through the corresponding eyelet.

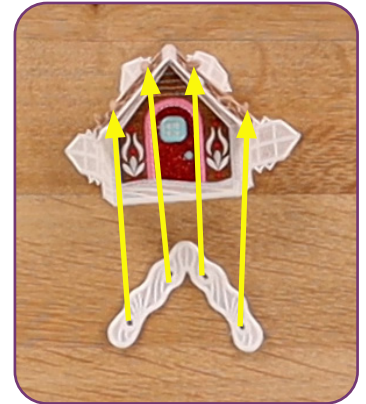

□ Step 36

- Insert the locking tabs of the Front Door Walls FSA (51323-05) and Front Door Roof FSA (51323-06) into the tab entries of the Bottom Front Wall FSA (51323-02).

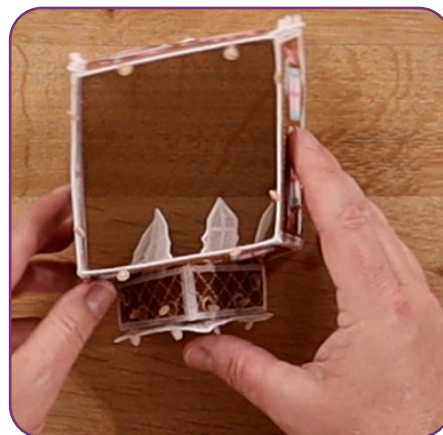
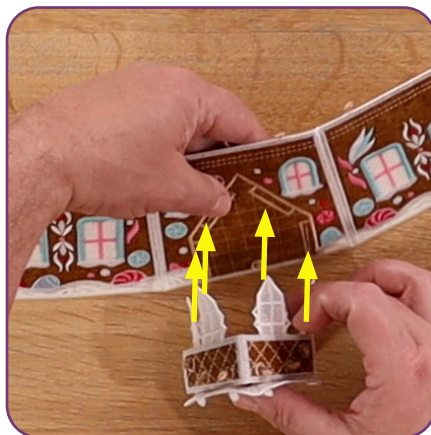

ASSEMBLY

Step 37

- Match the buttonettes of the bottom wall assembly to the eyelets of the Bottom Back Wall FSA (51323-04).
- Pull each buttonette through the corresponding eyelet.

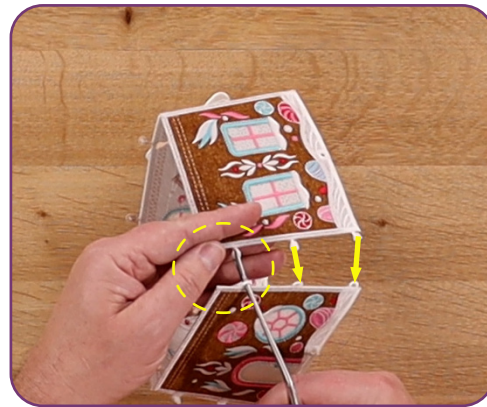

Step 38

- Match the buttonettes of the top wall assembly to the eyelets of the Top Back Wall FSA (51323-11).
- Pull each buttonette through the corresponding eyelet.

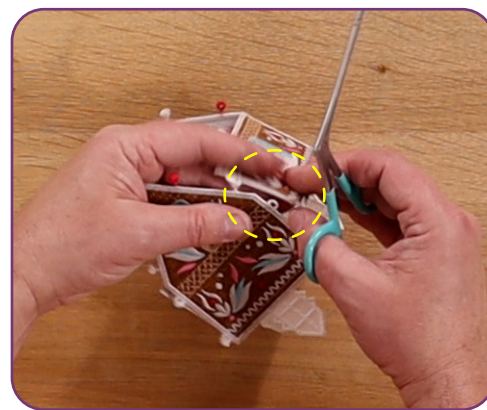

ASSEMBLY

Step 39

- Match the buttonettes of the top wall assembly to the eyelets of the Roof FSA (51323-12).
- Pull each buttonette through the corresponding eyelet.

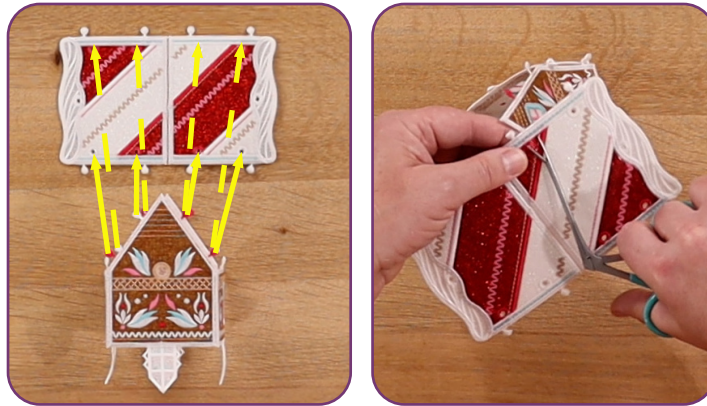

Step 40

- Match the Roof Snow FSL (51323-13) eyelets to the buttonettes on both sides of the Roof FSA (51323-12).
- Pull each buttonette through the corresponding eyelet.



ASSEMBLY

Step 41

- Match the buttonettes of the bottom wall assembly to the eyelets of the Platform FSA (51323-14).
- Pull each buttonette through the corresponding eyelet.

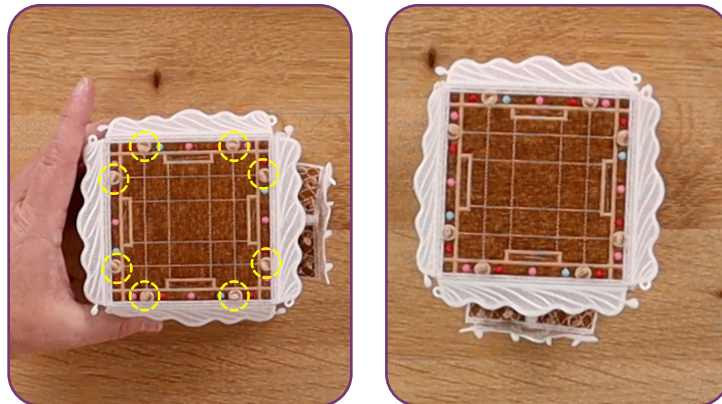

Step 42

- Bend at the folds and connect the buttonettes on the Platform FSA (51323-14) to their corresponding eyelets.

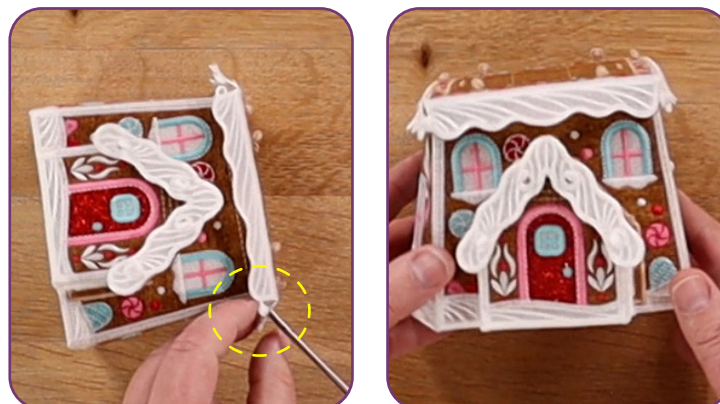

ASSEMBLY

Step 43

- Insert the dowel through the top wall assembly.



Step 44

- Insert the locking tabs of the top wall assembly into the tab entries of the Platform FSA (51323-14).

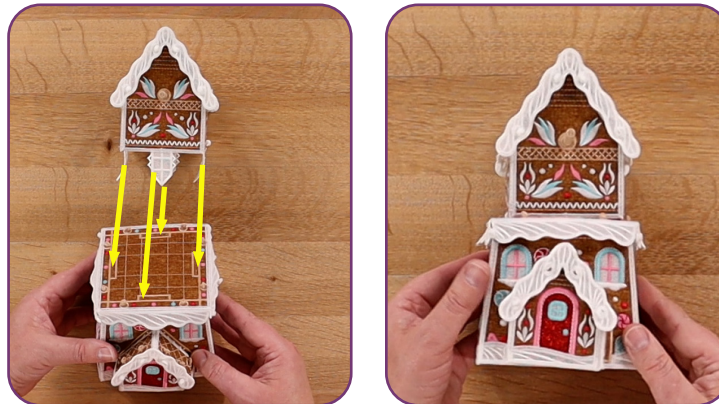

ASSEMBLY

□ Step 45

- Match the eyelets of the bottom wall assembly to the buttonettes of the Foundation FSA (51323-18).
- Pull each buttonette through the corresponding eyelet.

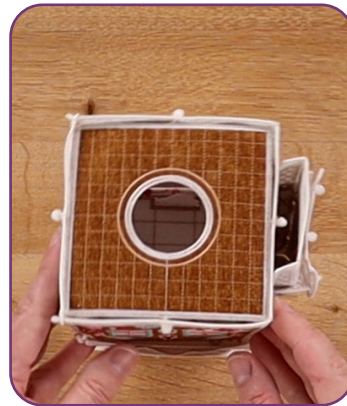
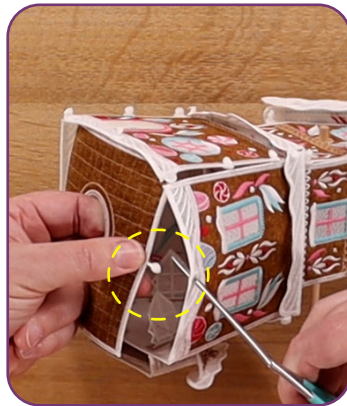

□ Step 46

- Slide the Back Blades Holder FSL (51323-15) onto the dowel.



ASSEMBLY

□ Step 47

- Slide the Blades FSA (51323-16) onto the dowel.



□ Step 48

- Slide the Front Blades Holder FSL (51323-17) onto the dowel.

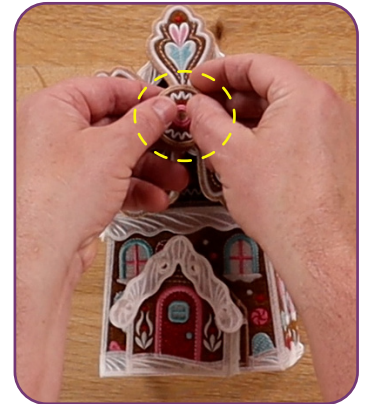

□ Step 49- Finishing Touches

- Add tea lights or pixie lights to create a glow.
- The project is complete. Enjoy!



PUNCH TOOL GUIDES

51323-02

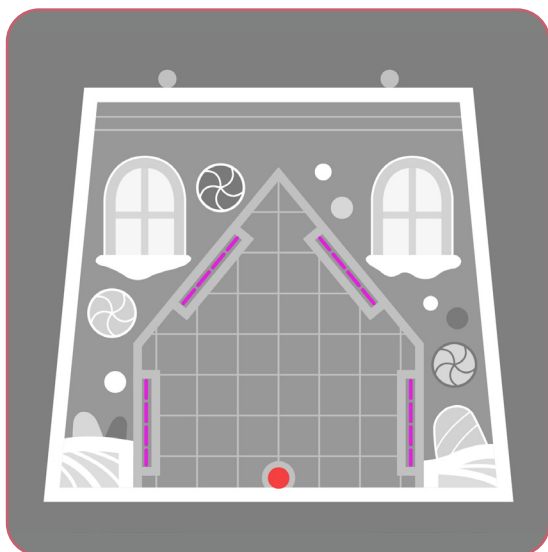

51323-06

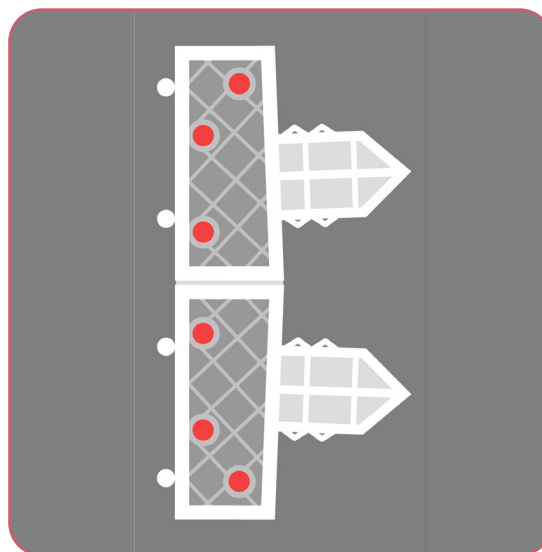

51323-13

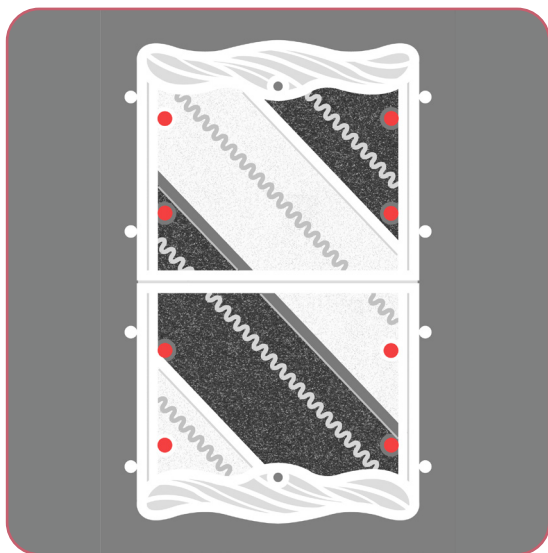

51323-15

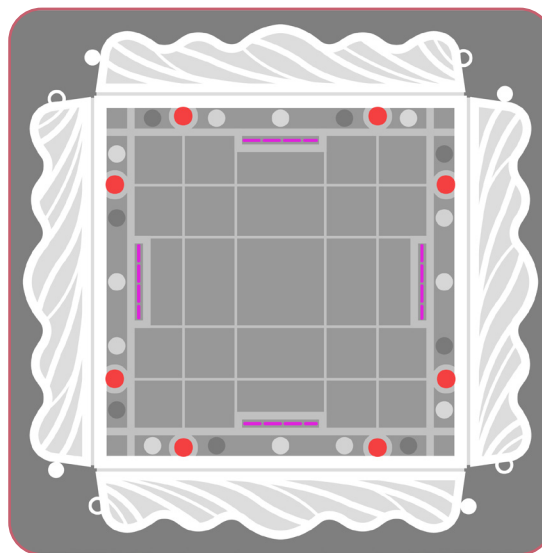

- = 2 MM
- = 3 MM
- = 4 MM

CRAFT KNIFE



PRINTING INSTRUCTIONS



ATTENTION

When printing this document, any page scaling or page fitting options in your print dialog box must be turned OFF or set to NONE so that your files will print out at their actual size. Images not printed at actual size will not function as intended.

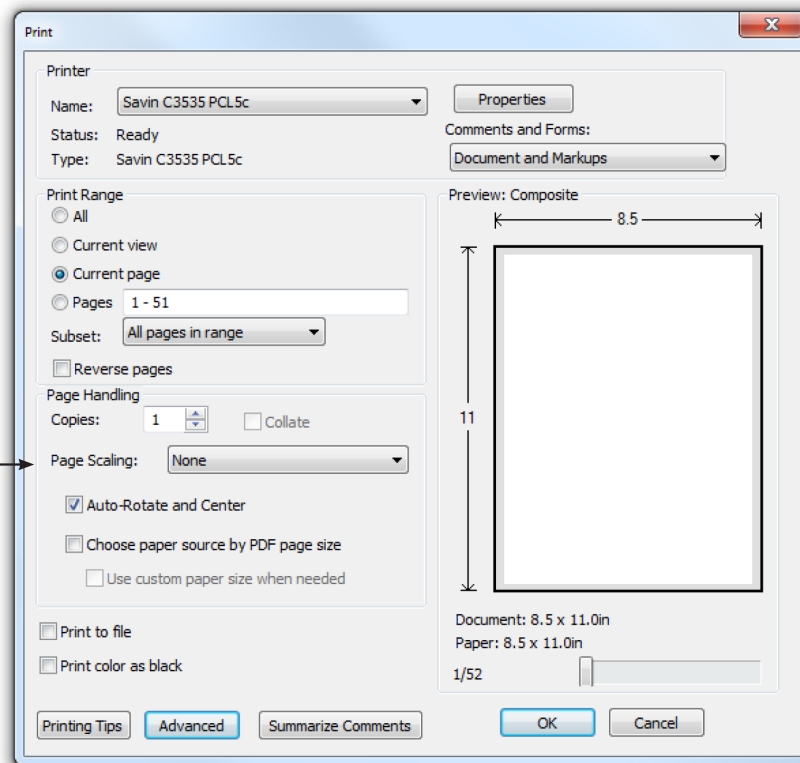

TO SAVE PAPER

Only print the desired image by navigating to the image's page, go to File > Print and select "Current page" in the print dialog box. Repeat for each desired image.

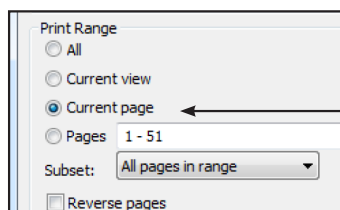

APPLIQUE PATTERNS



Print at 100%. No scaling. This box measures 1" x 1". Use the box as an accuracy guide when printing templates.

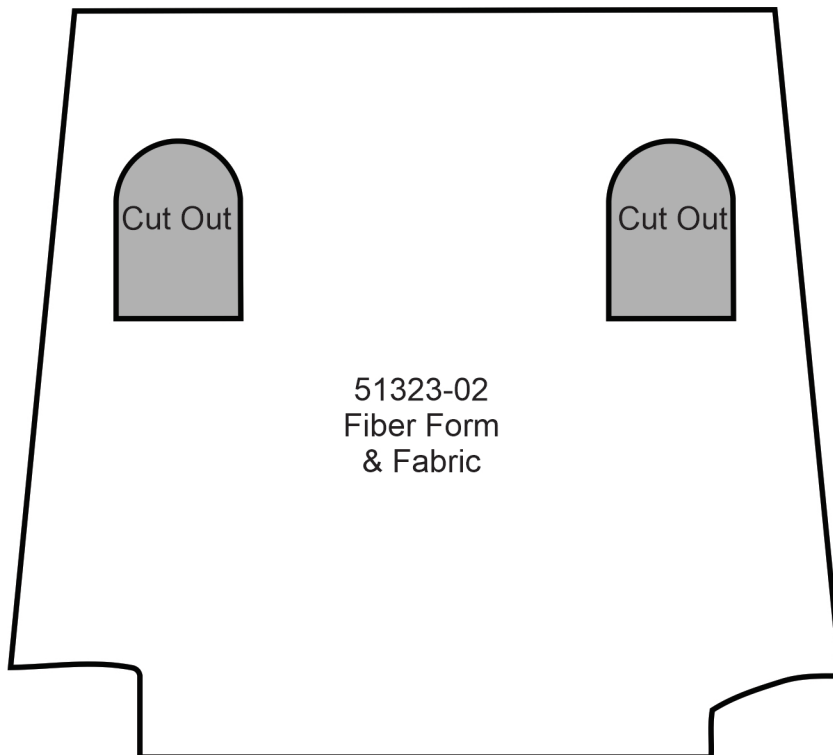
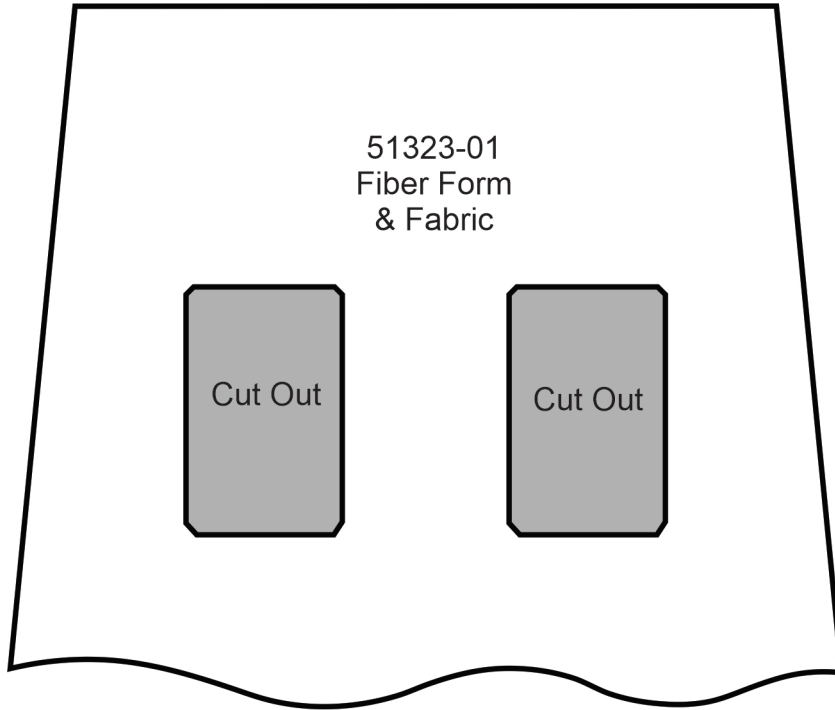

APPLIQUE PATTERNS



Print at 100%. No scaling. This box measures 1" x 1". Use the box as an accuracy guide when printing templates.

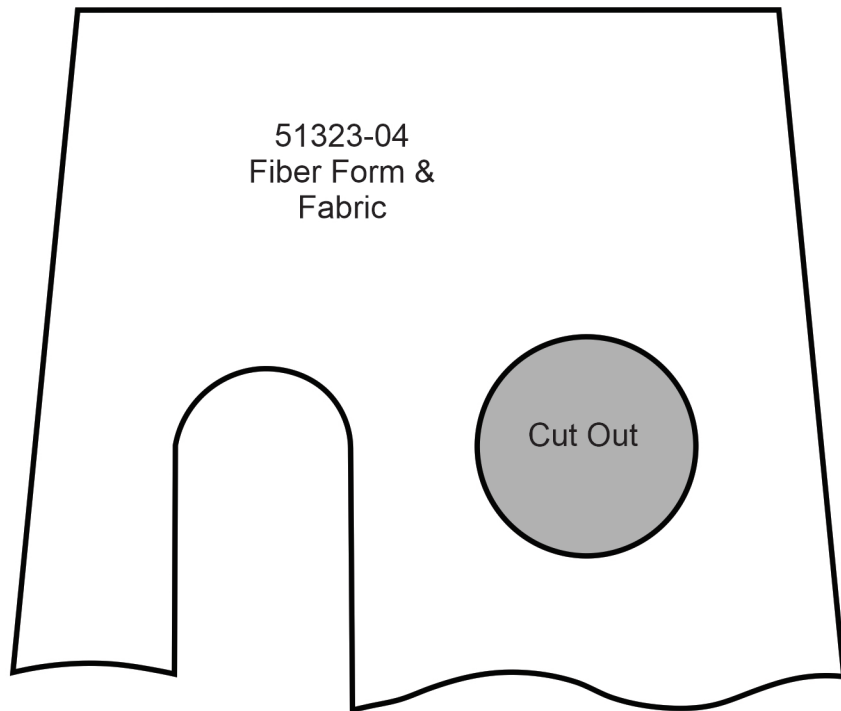
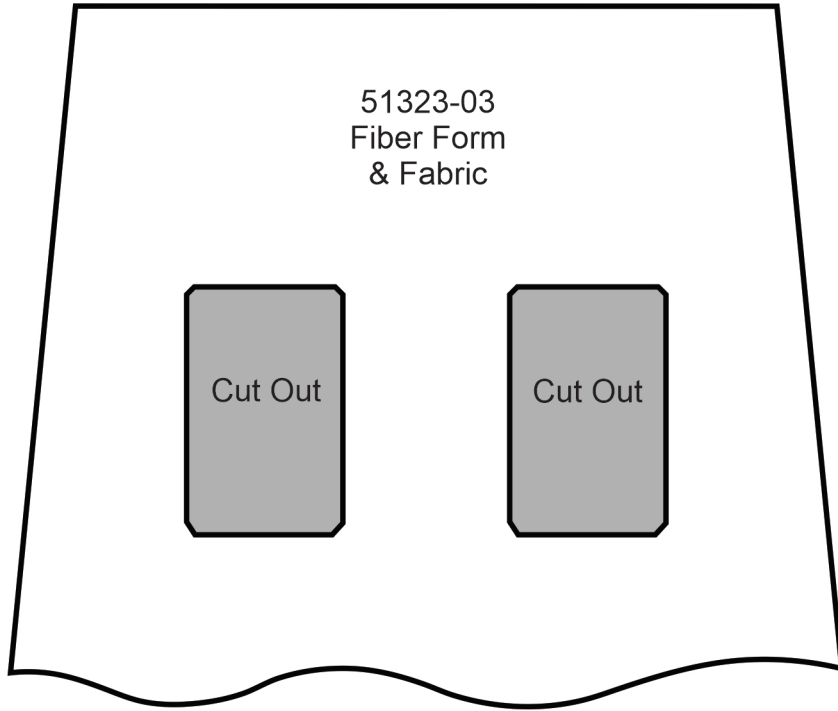

APPLIQUE PATTERNS

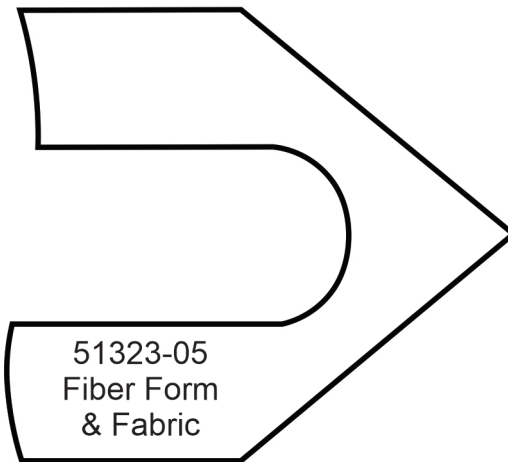
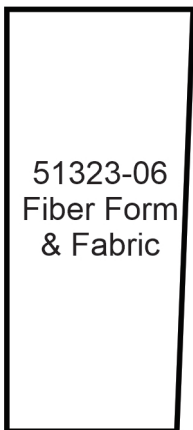

Print at 100%. No scaling. This box measures 1" x 1". Use the box as an accuracy guide when printing templates.

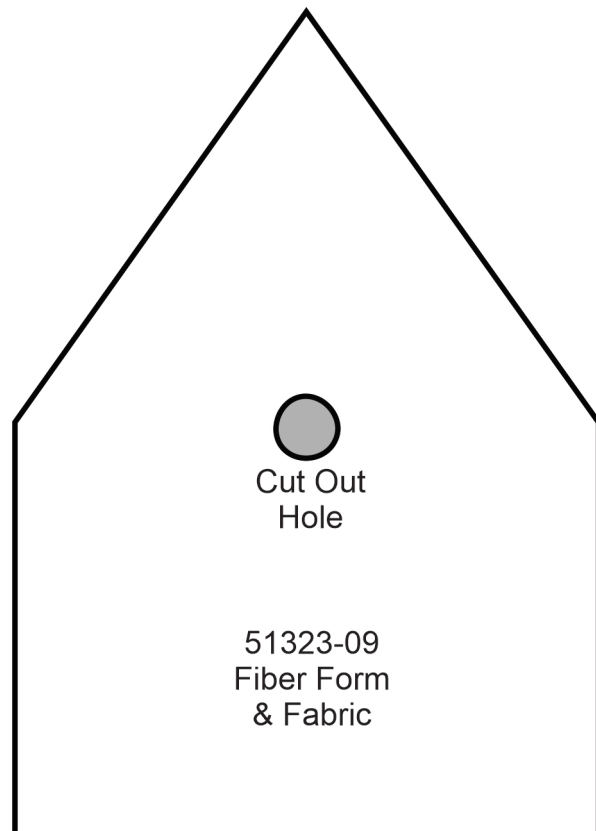
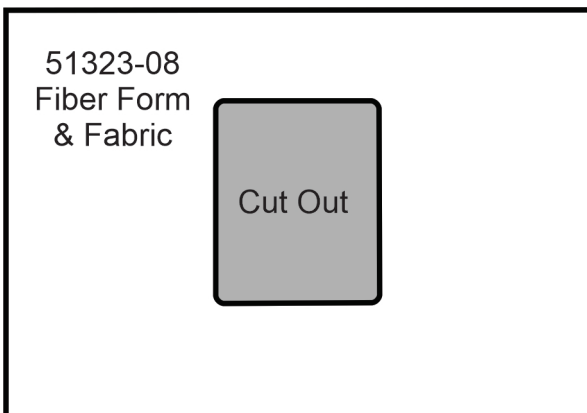

APPLIQUE PATTERNS

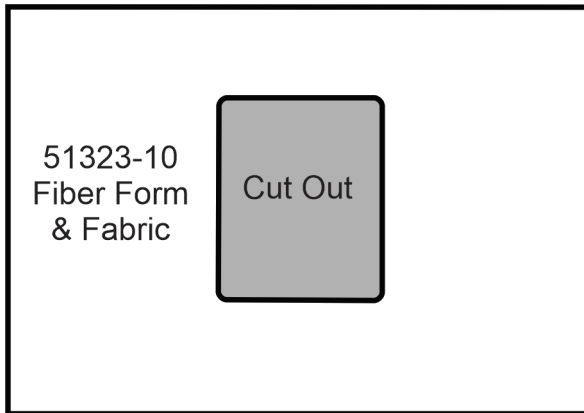

Print at 100%. No scaling. This box measures 1" x 1". Use the box as an accuracy guide when printing templates.

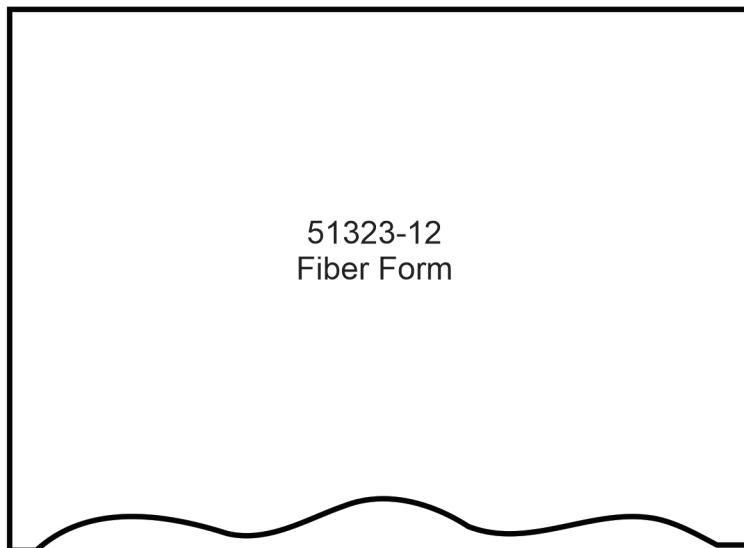
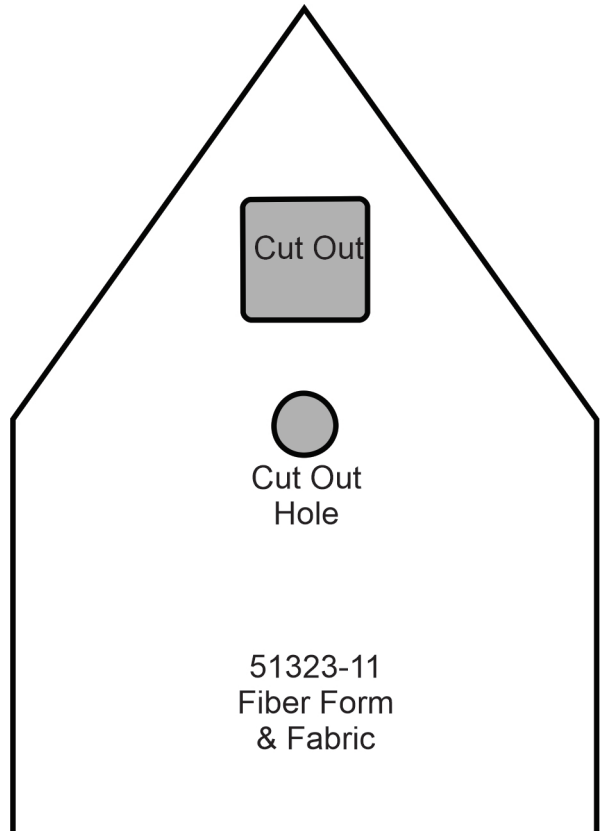
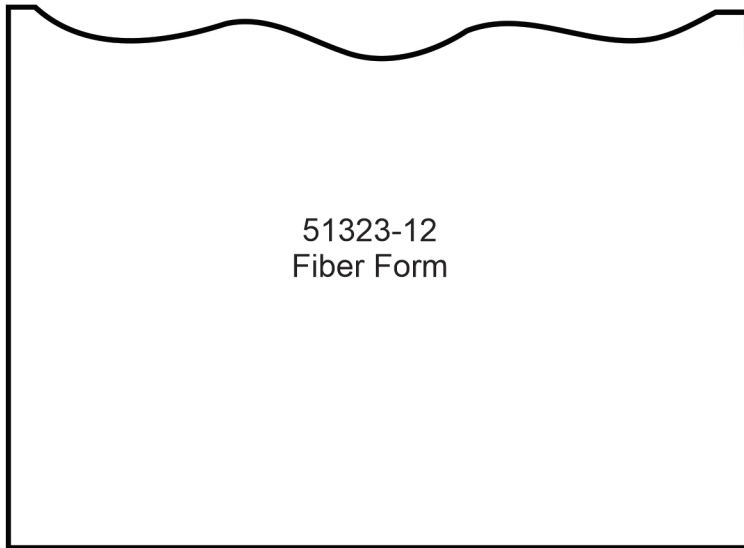

APPLIQUE PATTERNS



Print at 100%. No scaling. This box measures 1" x 1". Use the box as an accuracy guide when printing templates.

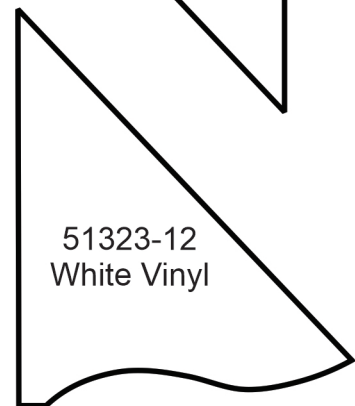
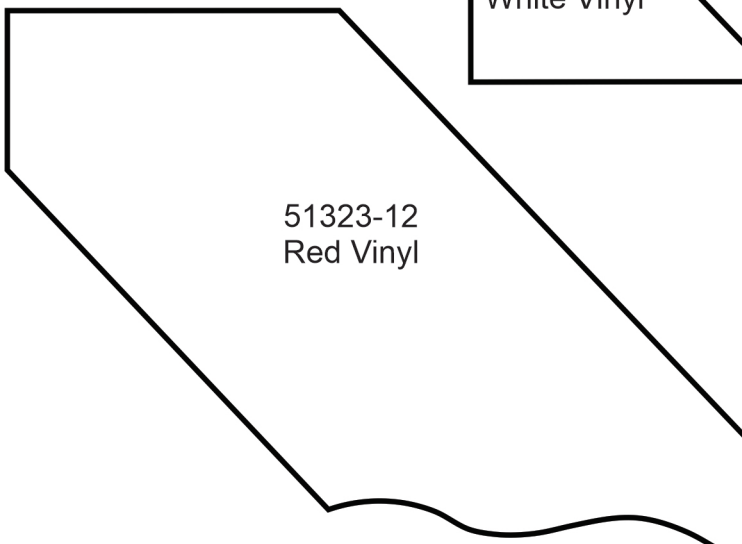
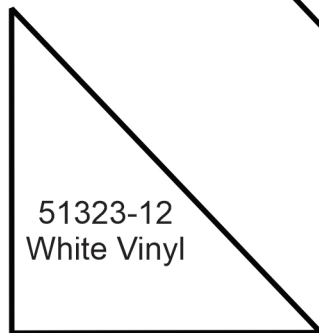
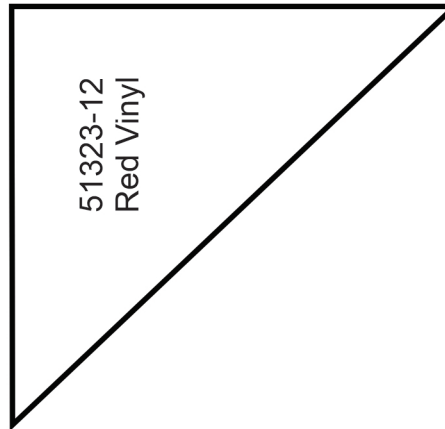
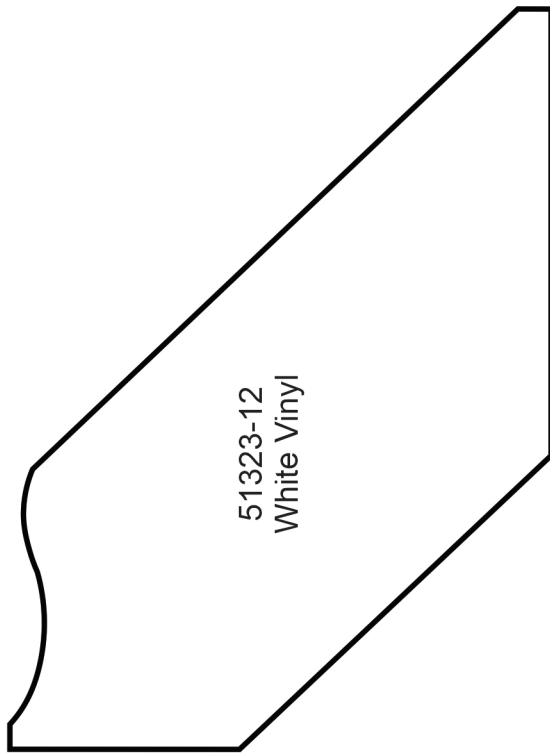

APPLIQUE PATTERNS



Print at 100%. No scaling. This box measures 1" x 1". Use the box as an accuracy guide when printing templates.

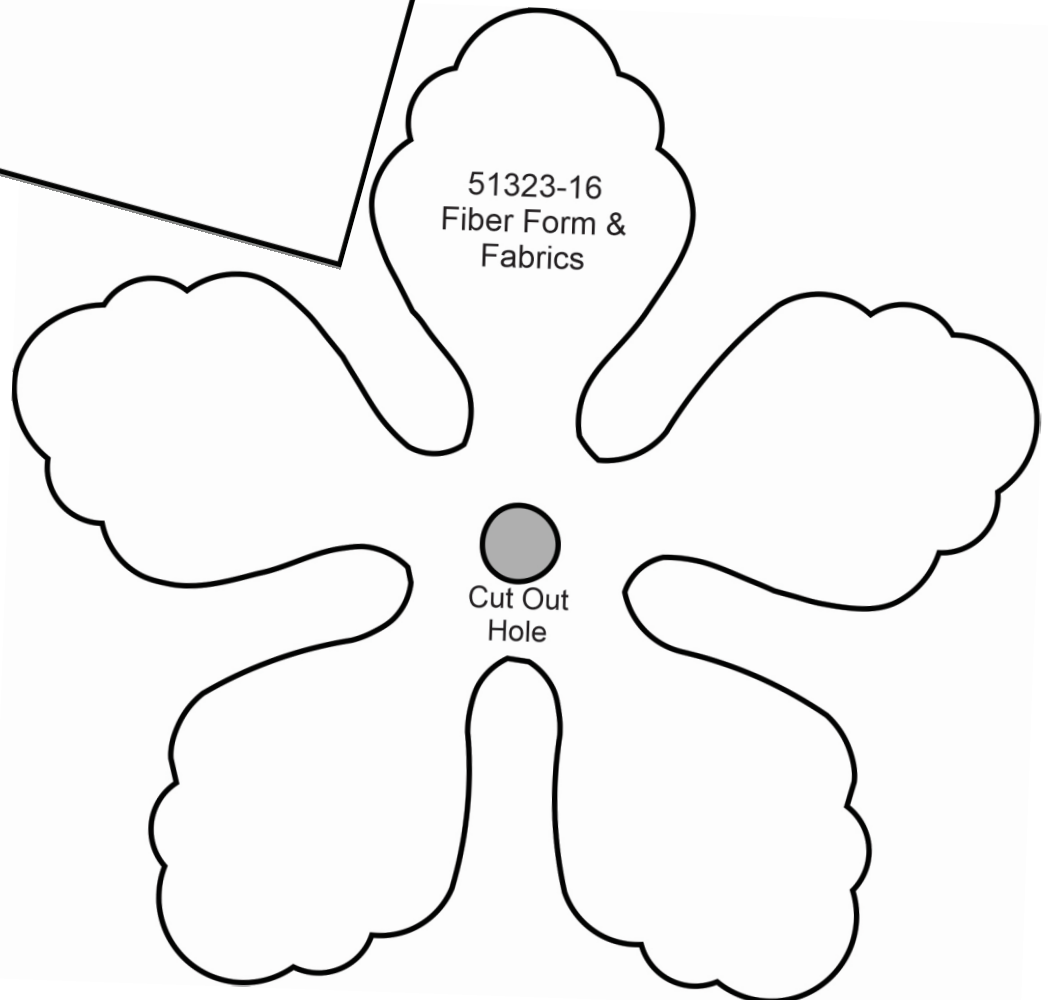
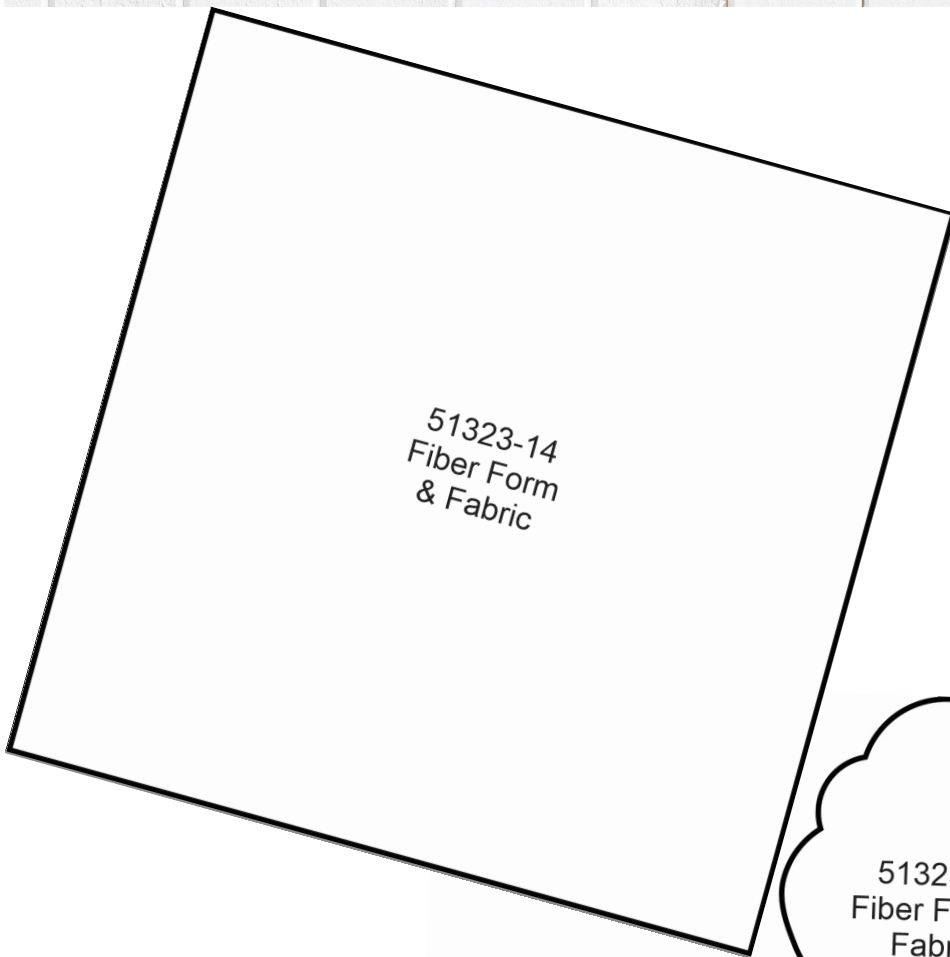

APPLIQUE PATTERNS

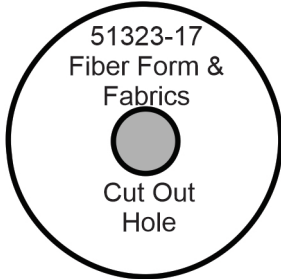

Print at 100%. No scaling. This box measures 1" x 1". Use the box as an accuracy guide when printing templates.

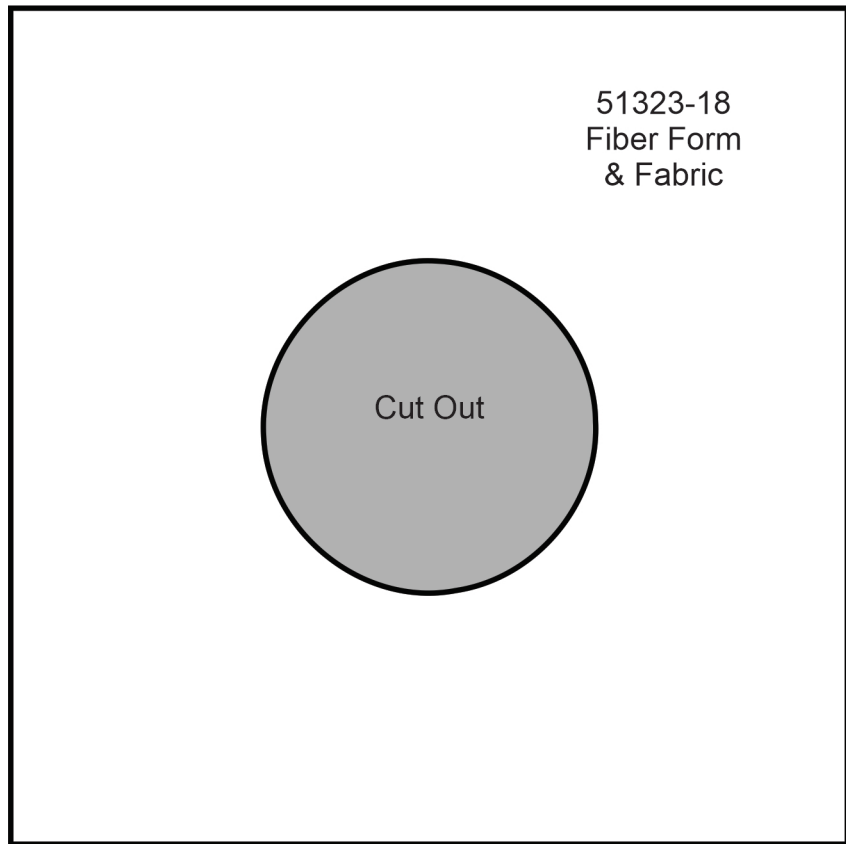

MIRRORED PATTERNS

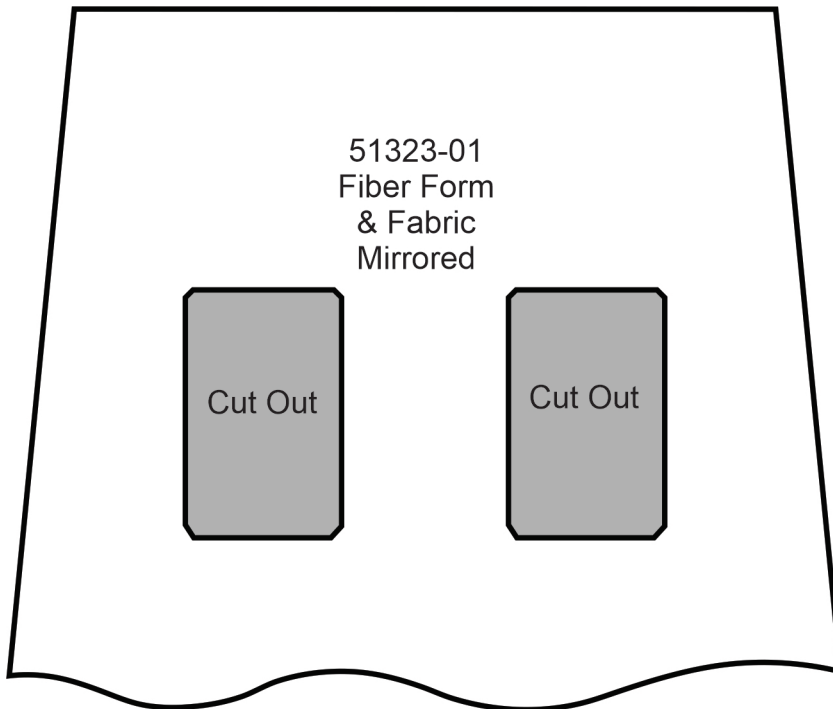

Print at 100%. No scaling. This box measures 1" x 1". Use the box as an accuracy guide when printing templates.

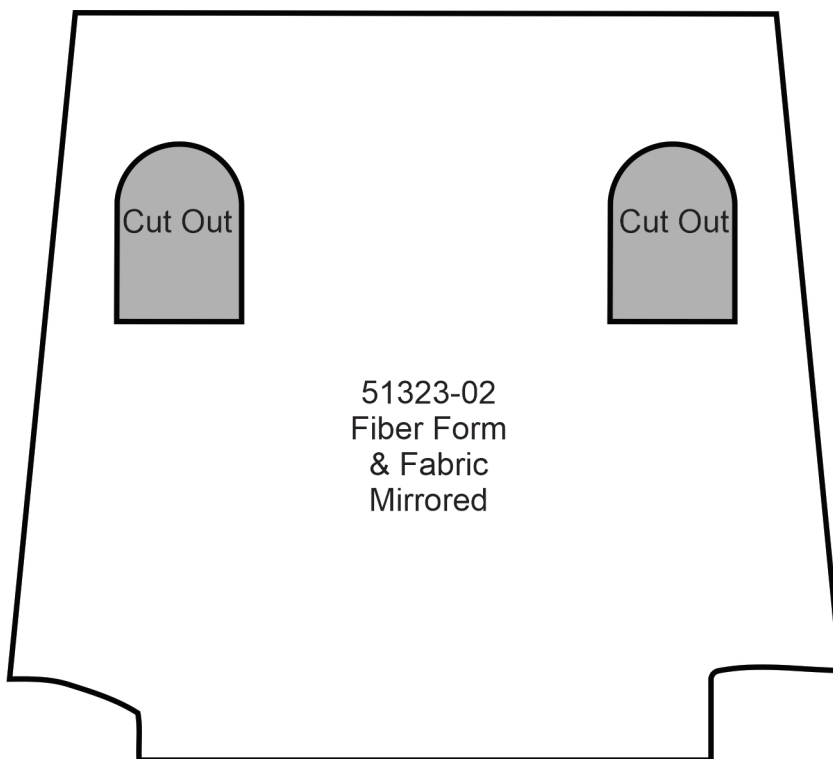

MIRRORED PATTERNS



Print at 100%. No scaling. This box measures 1" x 1". Use the box as an accuracy guide when printing templates.

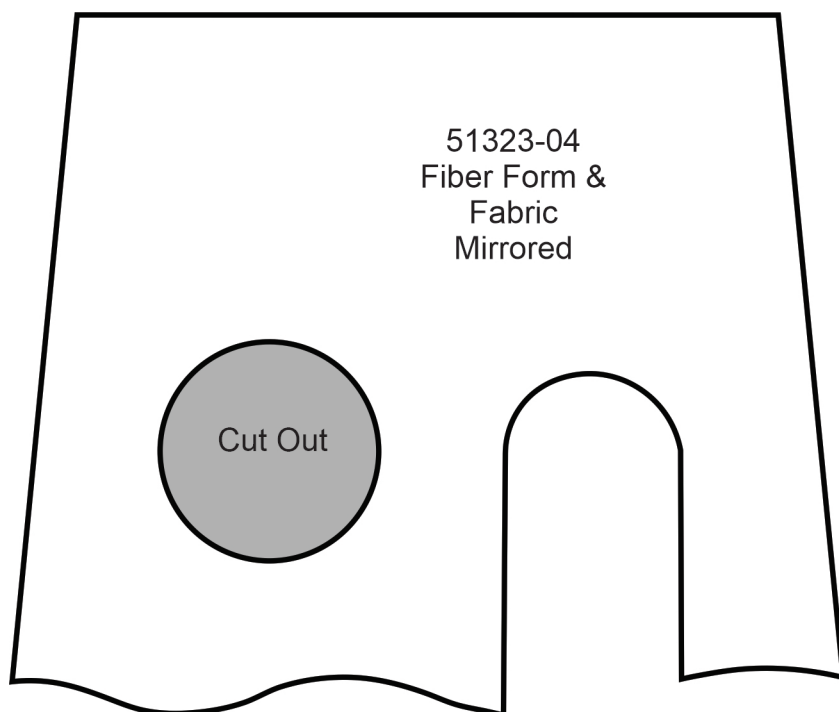
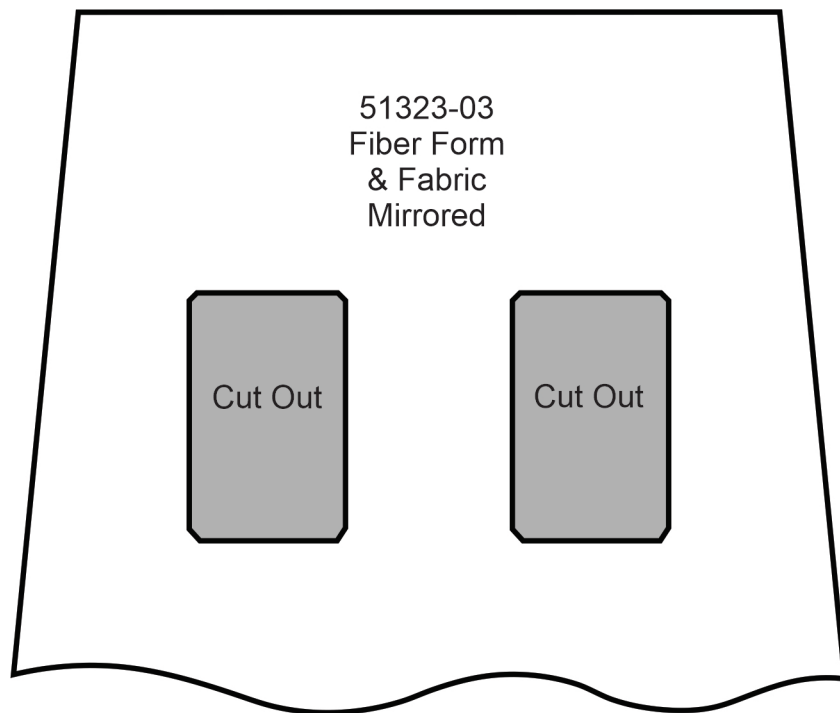

MIRRORED PATTERNS



Print at 100%. No scaling. This box measures 1" x 1". Use the box as an accuracy guide when printing templates.

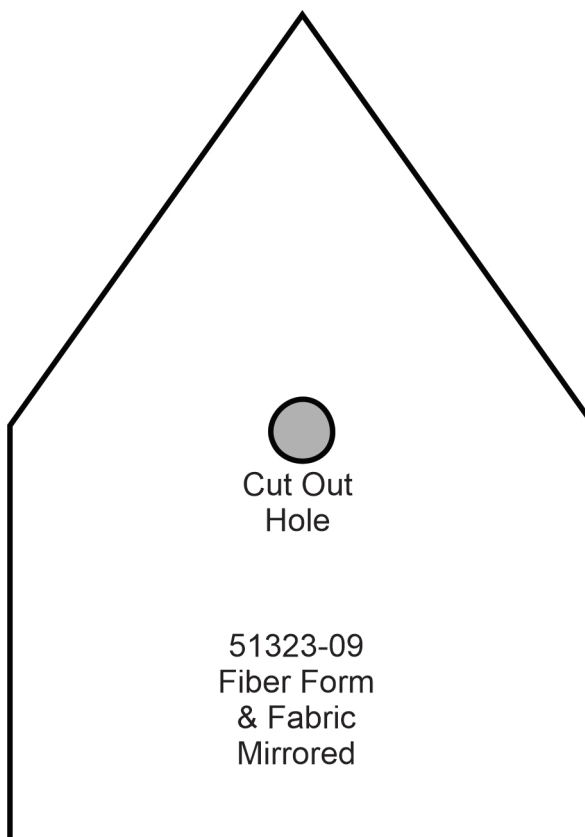
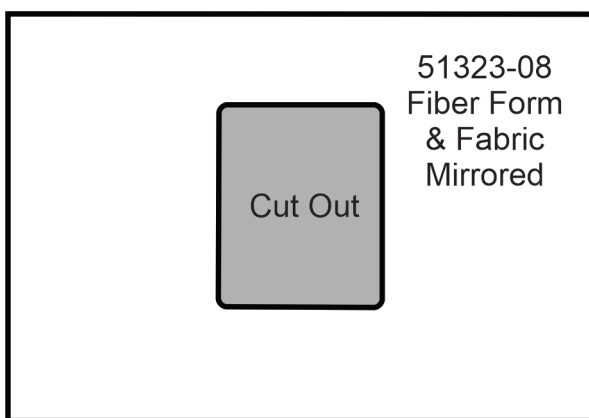
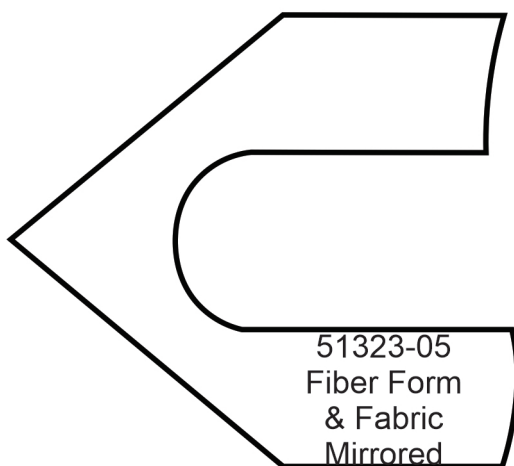
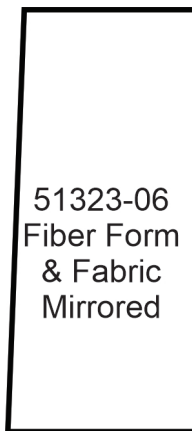

MIRRORED PATTERNS

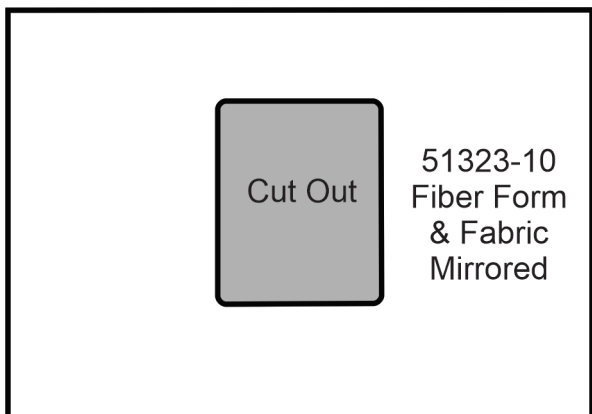

Print at 100%. No scaling. This box measures 1" x 1". Use the box as an accuracy guide when printing templates.

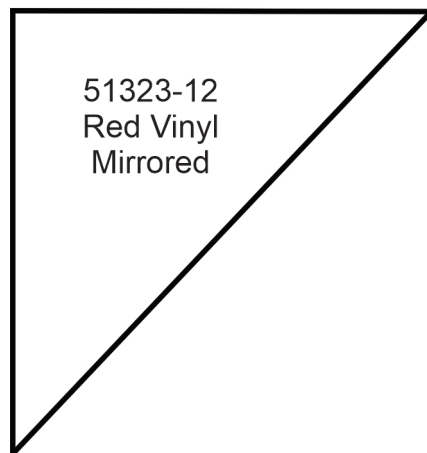
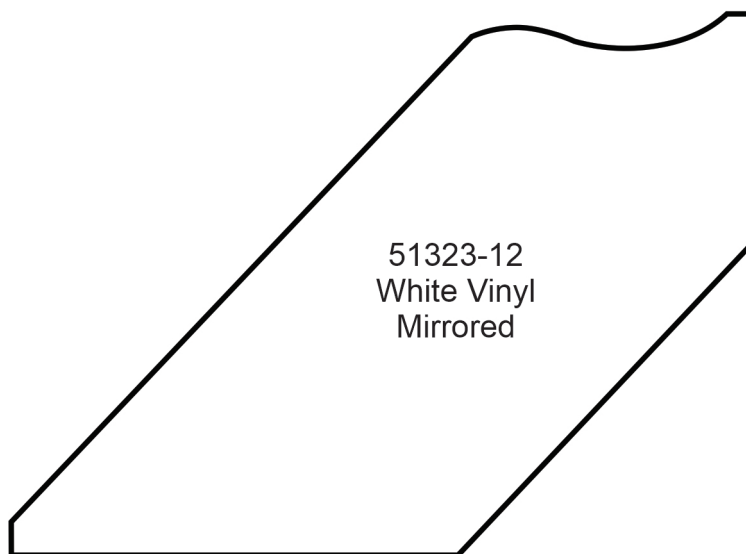
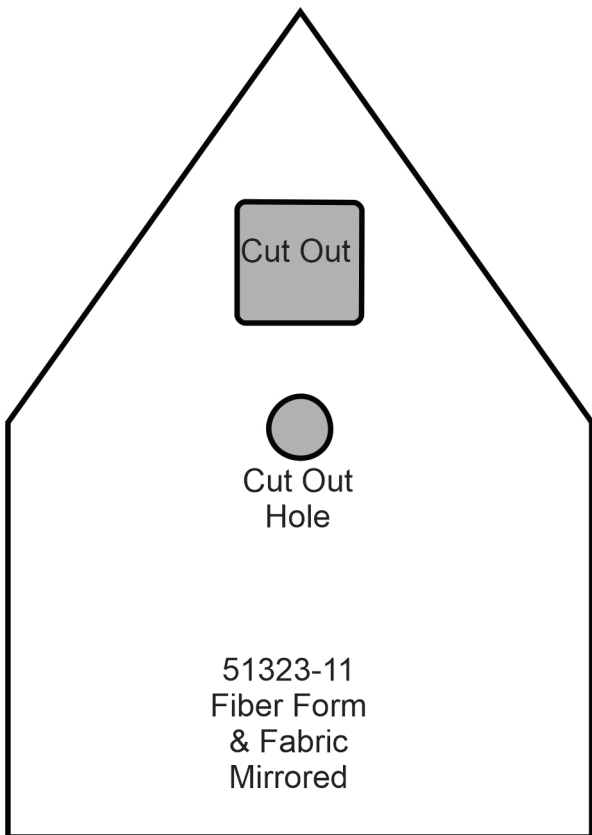

MIRRORED PATTERNS

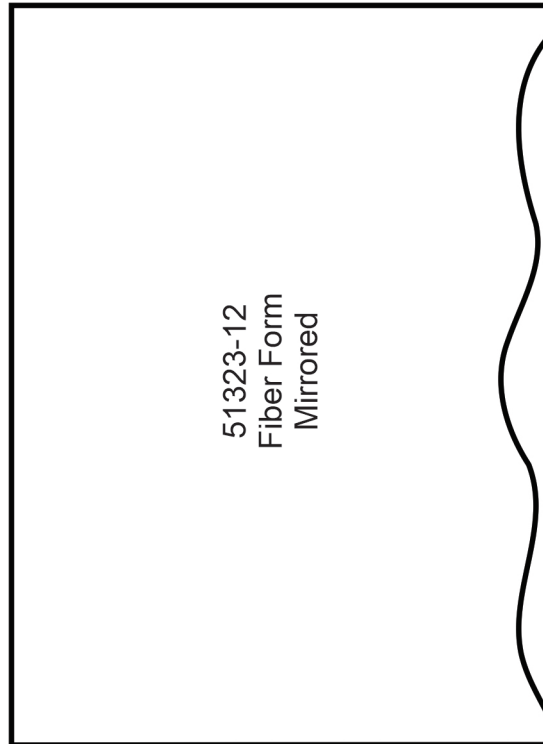
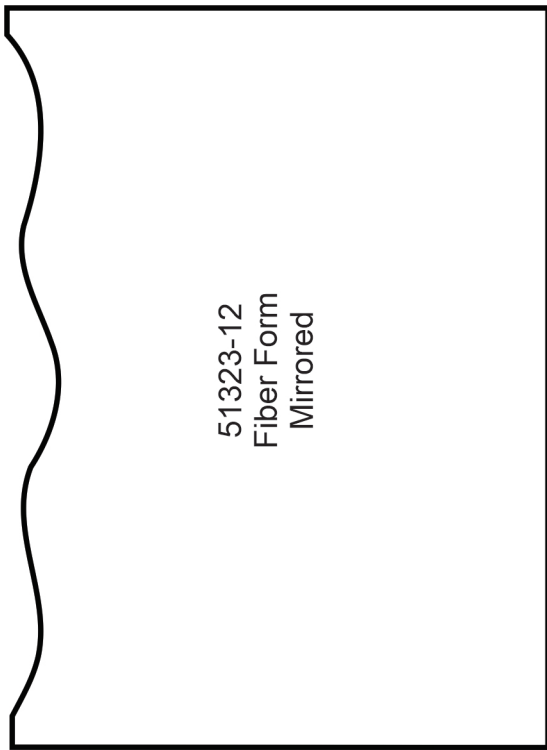

Print at 100%. No scaling. This box measures 1" x 1". Use the box as an accuracy guide when printing templates.

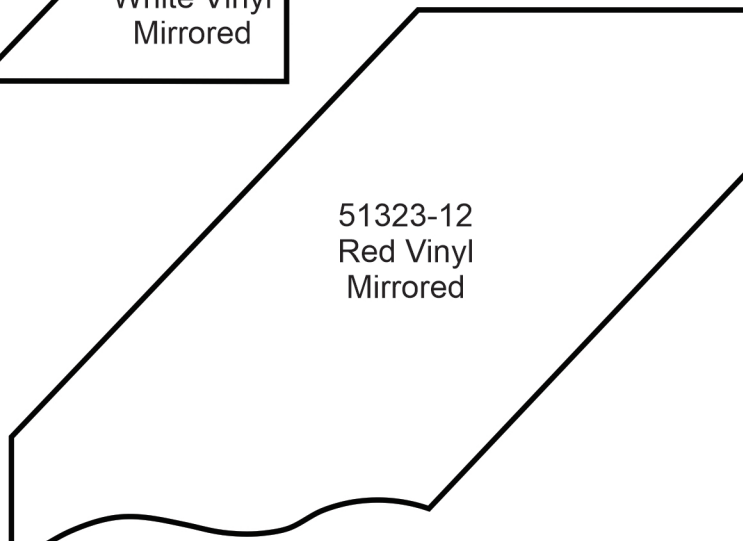
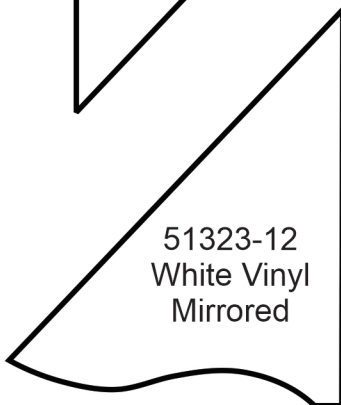
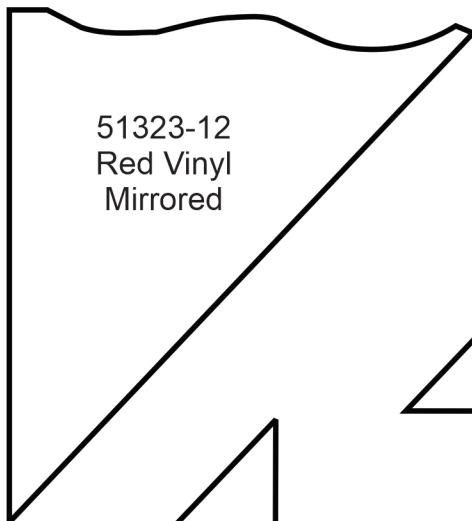

MIRRORED PATTERNS



Print at 100%. No scaling. This box measures 1" x 1". Use the box as an accuracy guide when printing templates.

51323-14
Fiber Form
& Fabric
Mirrored

51323-16
Fiber Form &
Fabrics
Mirrored

Cut Out
Hole

MIRRORED PATTERNS



Print at 100%. No scaling. This box measures 1" x 1". Use the box as an accuracy guide when printing templates.

