

Note: Some designs in this collection may have been created using unique special stitches and/or techniques. To preserve design integrity when rescaling or rotating designs in your software, always rescale or rotate designs using the handles directly on-screen.

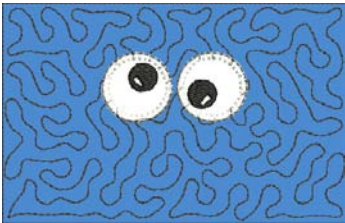

### 12527-01 Monster Eyes Appliqué

5.00 X 3.19 in.  
127.00 X 81.03 mm  
2,242 St. **⌘**

### 12527-02 Piggy Face Appliqué

5.00 X 3.19 in.  
127.00 X 81.03 mm  
3,088 St. **⌘**

### 12527-03 Finger Hot Pot Appliqué

4.86 X 6.55 in.  
123.44 X 166.37 mm  
3,379 St. **⌘ L**

Listings below indicate color sample, stitching order and suggested thread color number. Most numbers indicate Isacord thread. Colors beginning with 20501 refer to YLI Fine Metallics, 7 refer to Yenmet Metallic, 8 refer to YLI Variations Variegated Thread and 9 refer to Isacord Multicolor Variegated.

#### 12527-01 Monster Eyes Appliqué

■	1. Design Placement Stitch.....	0020
■	2. Stipple.....	0020
■	3. Eyes Placement Stitch.....	0020
□	4. Eyes Tackdown.....	0015
■	5. Pupils.....	0020

#### 12527-02 Piggy Face Appliqué

■	1. Design Placement Stitch.....	0020
■	2. Stipple.....	0020
■	3. Eyes & Snout Placement Stitch.....	0020
□	4. Eyes Tackdown.....	0015
■	5. Snout Tackdown.....	2250
■	6. Pupils & Nostrils.....	0020

#### 12527-03 Finger Hot Pot Appliqué

■	1. Outer Mouth Placement Stitch.....	0020
■	2. Outer Mouth Tackdown.....	0020
■	3. Inner Mouth Placement Stitch.....	0020
■	4. Inner Mouth Tackdown.....	0020
■	5. Stipple.....	0020
■	6. Finger Placement Stitch.....	0020
■	7. Finger Tackdown.....	0020
■	8. Seam Stitch.....	0020

**⌘** Design contains a loose fill.

**⊗** Some solid areas shown are not stitched.

**L** Design is larger than 5" (127 mm) in either direction.

**S** Design is smaller than 1.5" (38.1 mm) in either direction.

It is a violation of Copyright law to make and distribute copies of electronic designs or artwork.

Electronic designs are licensed to the original purchaser for use at one location. ©2014 OESD, LLC. All rights reserved.

1. Print out the necessary pages from the PDF of the appliqué pattern(s).
2. Mark the right side of the pattern pieces so you'll know which direction to lay the pattern on the fabric.
3. Lightly spray the wrong side of the pattern pieces with temporary adhesive spray and allow it to set for a few minutes.
4. Place the pattern pieces on the right side of the fabric and carefully cut them out. **PHOTO 1**
5. Sew the placement stitch on your hooped fabric. **PHOTO 2**
6. With the paper still stuck to the right side of the appliqué fabric, spray the wrong side of the fabric with temporary spray adhesive.
7. Place the fabric inside the sewing placement stitch so that it matches the stitching line, and then remove the paper pattern. **PHOTO 3**
8. Sew the tackdown. **PHOTO 4**
9. Sew the remainder of the design and repeat for any remaining pieces. **PHOTO 5**

**NOTE:** The patterns are sized for the designs as they were made. If you resize the design, you will need to resize the pattern the same amount. You can print out the pattern at the normal size then copy it on a copy machine at the changed size. For example, resize the designs to 80%, resize the printed pattern to 80%.

**TIP:** When Printing the patterns, make sure that the “Fit to page” option is **UNCHECKED** in the Print Dialog Box. If this option is checked the printed patterns will not be actual size.

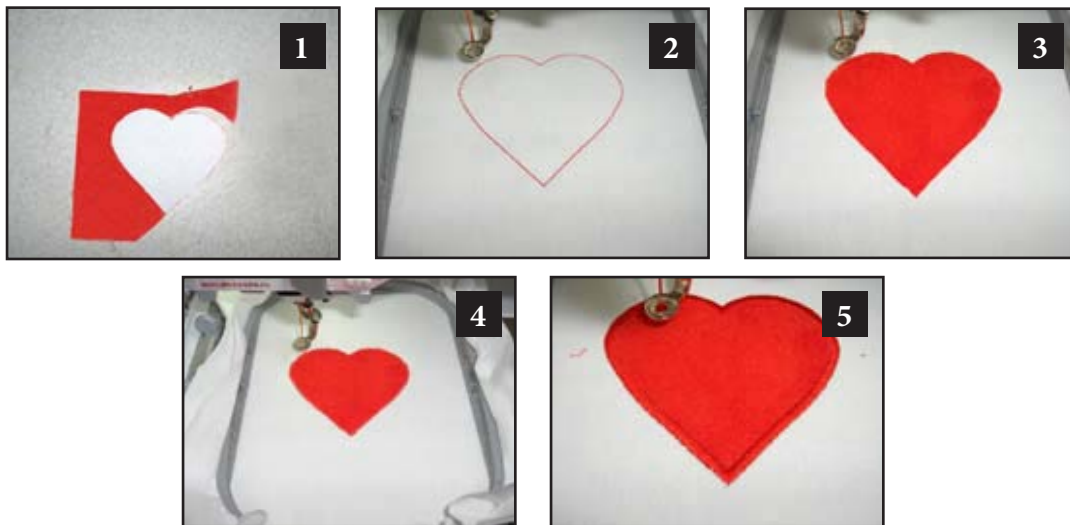

## ATTENTION

When printing this document, any page scaling or page fitting options in your print dialog box must be turned OFF or set to NONE so that your files will print out at their actual size. Images not printed at actual size will not function as intended.

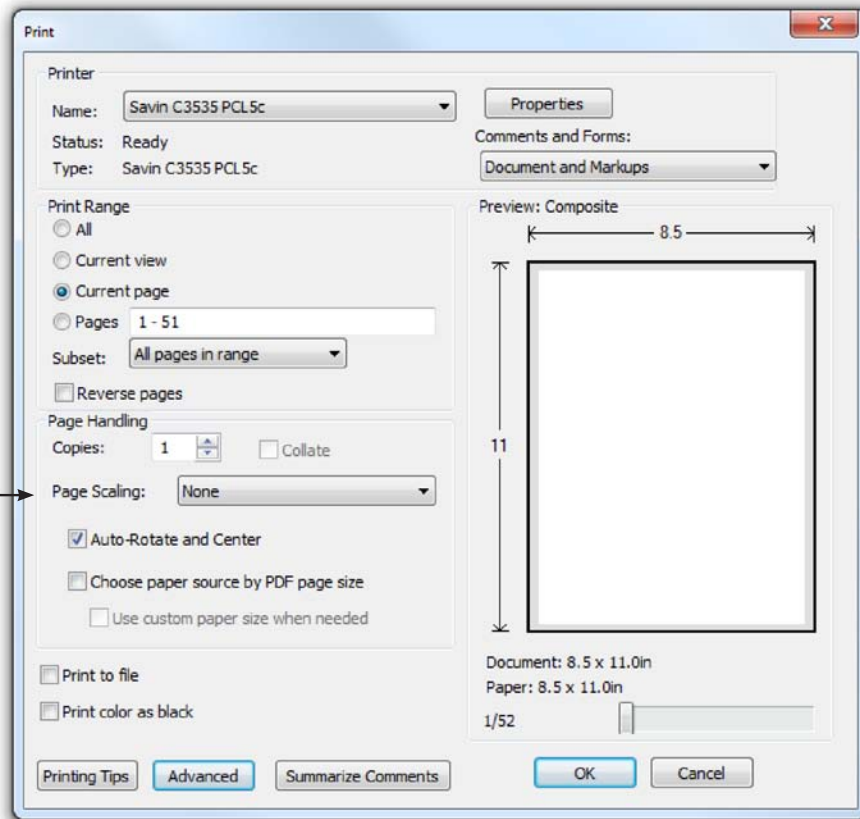

## TO SAVE PAPER

Only print the desired image by navigating to the image's page, go to File > Print and select "Current page" in the print dialog box. Repeat for each desired image.

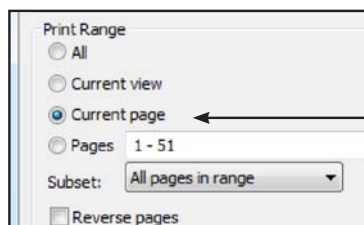

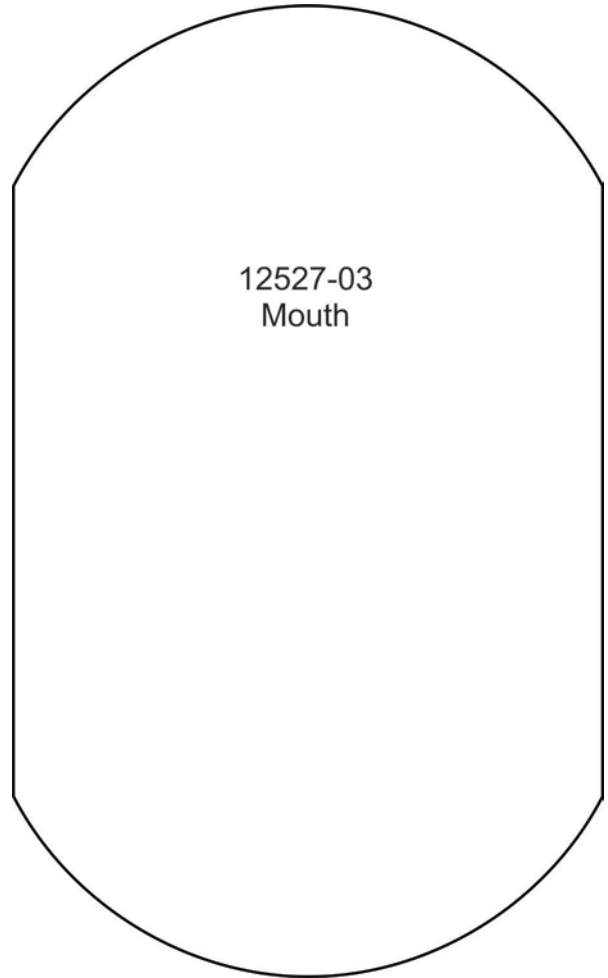

These fun and simple In the Hoop Finger Pot Holders #12527 made in the hoop of your embroidery machine are great for the young cooks in the house. There are two different looks – one resembles a pink piggy and the other a blue monster. The finger pot holders can be made in any fabrics and colors. They are lots of fun to cook with for all ages. Enjoy your Finger Pot Holder!

### Supplies

- OESD embroidery collection In the Hoop Finger Pot Holders #12527
- Medium tear away stabilizer
- ¼ yd. fabric (main fabric of the finger pot holder)
- 6" x 20" or ¼ yd. cotton batting
- 6" x 8" piece Insul-Bright
- 2" x 3" piece white fabric (eyes appliqué)
- 4" x 6" piece fabric (inner mouth appliqué)
- 1 ½" x 2" piece fabric (snout appliqué – only for piggy)
- OESD Appliqué Fuse & Stick
- Embroidery threads
- *Optional:* Temporary spray adhesive



### Cut

- Prepare the appliqué fabrics with the Fuse and Stick following the manufacturer's directions before cutting appliqué pieces.
- (4) 6" x 8" pieces fabric (main fabric)(two will be folded in half wrong sides together to form 6" x 4" piece)
- (1) 6" x 8" piece cotton batting
- (2) 6" x 4" pieces cotton batting

After cutting, place a 6" x 4" piece cotton batting inside each of the folded main fabric pieces. Layer one 6" x 8" piece fabric wrong side up, cotton batting and Insul-Bright. Set aside.

**NOTE:** To make the monster, use files #12527-01 (Monster Eyes Appliqué) and #12527-03 (Finger Hot Pot). To make the piggy, use files #12527-02 (Piggy Face Appliqué) and #12527-03 (Finger Hot Pot Appliqué).

### Monster Eyes Appliqué (#12527-01) OR Piggy Face Appliqué

(#12527-02) **Instructions** (Photos of the Piggy Face Appliqué will be shown.)

- Hoop tear away stabilizer.
- Stitch first stitch of embroidery design which is the Design Placement Stitch.

#### PHOTO 1

*Optional:* Using temporary spray adhesive, lightly spray over the placement stitch.

- Center and place one of the folded 6" x 4" piece main fabric with cotton batting inside with the folded edge on the placement stitch, overlapping the bottom line by ¼". Stitch the second stitch of embroidery design called Stipple. **PHOTO 2**
- Stitch the next stitch which is the Eyes Placement Stitch for the monster or the Eyes and Snout Placement

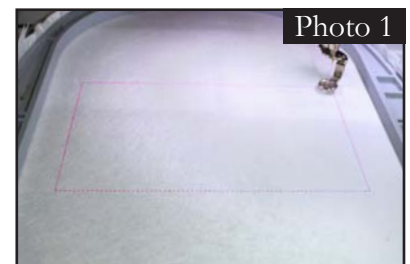

Photo 1



Photo 2



Stitch for the piggy.

- Place the eyes appliqué for the monster or the eyes and snout appliqués for the piggy over the placement stitch. Stitch the next stitch called Eyes Tackdown. For the piggy, change colors of thread and stitch the next stitch called Snout Tackdown.

**PHOTO 3**

- Stitch the final color which is the Pupils for the monster or Pupils and Nostrils for the piggy. Set aside. **PHOTOS 4 & 5**

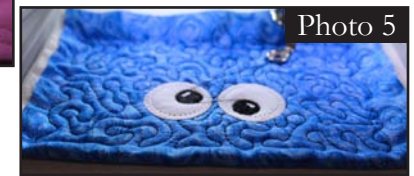

### Finger Hot Pot Appliqué (#12527-03) Instructions

- Hoop tear away stabilizer.
- Stitch the first stitch which is the Outer Mouth Placement Stitch. **PHOTO 6**

*Optional:* Using temporary spray adhesive, lightly spray over the placement stitch.

- Center and place the layered main fabric, batting and Insul-Bright right side up over the Outer Mouth Placement Stitch.

- Stitch the next color called Outer Mouth Tackdown. **PHOTO 7**

- Stitch the next color called Inner Mouth Placement Stitch. **PHOTO 8**

- Place the inner mouth appliqué over the placement stitch. Stitch the next color which is the Inner Mouth Tackdown. **PHOTO 9**

- Stitch the next two colors called Stipple and Finger Placement Stitch. **PHOTO 10**

- Right sides together, place the monster eyes appliqué or the piggy face appliqué and the other folded 6" x 4" piece main fabric with batting with the folded edges over the placement stitch lines by 1/4". **PHOTO 11**

- Stitch the Finger Tackdown. **NOTE:** Be watchful as this stitches as the folded pieces may shift. **PHOTO 12**

- Place remaining main fabric right side down over pot holder. Stitch the final stitch called Seam Stitch.

**NOTE:** There will be an opening on one side of the pot holder for turning right side out. **PHOTO 13**

- Remove the finger pot holder from the hoop and trim excess stabilizer and fabric about 1/4" from Seam Stitch and 1" around the opening for turning. **PHOTO 14**

- Turn the outer fabrics right side out. Slip stitch the opening closed. Flip the pockets out. **PHOTOS 15 & 16**

- Have fun making the monster or piggy In the Hoop Finger Pot Holders!

