

Note: Some designs in this collection may have been created using unique special stitches and/or techniques. To preserve design integrity when rescaling or rotating designs in your software, always rescale or rotate designs using the handles directly on-screen.



12525-01 Merry Tree Appliqué
3.97 X 6.80 in.
100.84 X 172.72 mm
8,566 St. **L**



12525-02 Merry Stocking Appliqué
3.85 X 6.69 in.
97.79 X 169.93 mm
8,311 St. **L**



12525-03 Merry Ornament Appliqué
4.34 X 6.44 in.
110.24 X 163.58 mm
8,609 St. **L**

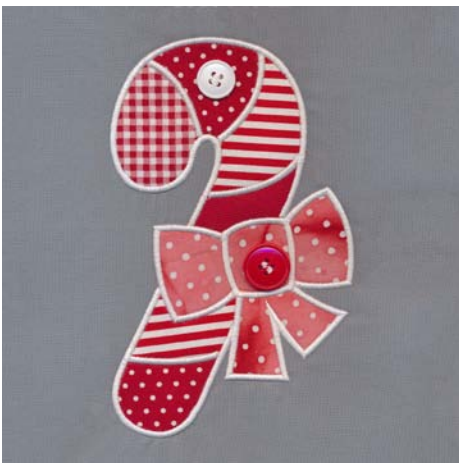

12525-04 Merry Cane Appliqué
4.12 X 6.72 in.
104.65 X 170.69 mm
11,853 St. **L**



12525-05 Merry Wreath Appliqué
4.81 X 6.16 in.
122.17 X 156.46 mm
11,424 St. **L**



12525-06 Merry Heart Appliqué
4.81 X 5.28 in.
122.17 X 134.11 mm
8,279 St. **L**

⌘ Design contains a loose fill.

⚙ Some solid areas are not stitched.

L Design is larger than 5" (127 mm) in either direction.

S Design is smaller than 1.5" (38.1 mm) in either direction.

It is a violation of Copyright law to make and distribute copies of electronic designs or artwork.

Electronic designs are licensed to the original purchaser for use at one location. ©2014 OESD, LLC. All rights reserved.



Merry Appliqués

#12525 / 6 Designs

Listings below indicate color sample, stitching order and suggested thread color number. "I" refers to Isacord thread and "T" refers to Timeless thread. Colors beginning with 20501 refer to YLI Fine Metallics, 7 refer to Yenmet Metallic, 8 refer to YLI Variations Variegated Thread and 9 refer to Isacord Multicolor Variegated.

		I	T			I	T			I	T				
12525-01 Merry Tree Appliqué															
<input type="checkbox"/>	1. Trunk Placement Stitch	0015	28154	<input type="checkbox"/>	1. Bottom Stripe Placement Stitch	0015	28154	<input type="checkbox"/>	1. Top Placement Stitch	0015	28154				
<input type="checkbox"/>	2. Cut Line & Tackdown	0015	28154	<input type="checkbox"/>	2. Cut Line & Tackdown	0015	28154	<input type="checkbox"/>	2. Cut Line & Tackdown	0015	28154				
<input type="checkbox"/>	3. Bottom Tree Section Placement Stitch	0015	28154	<input type="checkbox"/>	3. Middle Stripe Placement Stitch	0015	28154	<input type="checkbox"/>	3. Left Placement Stitch	0015	28154				
<input type="checkbox"/>	4. Cut Line & Tackdown	0015	28154	<input type="checkbox"/>	4. Cut Line & Tackdown	0015	28154	<input type="checkbox"/>	4. Cut Line & Tackdown	0015	28154				
<input type="checkbox"/>	5. Lower Middle Tree Section Placement Stitch	0015	28154	<input type="checkbox"/>	5. Top Stripe Placement Stitch	0015	28154	<input type="checkbox"/>	5. Right Placement Stitch	0015	28154				
<input type="checkbox"/>	6. Cut Line & Tackdown	0015	28154	<input type="checkbox"/>	6. Cut Line & Tackdown	0015	28154	<input type="checkbox"/>	6. Cut Line & Tackdown	0015	28154				
<input type="checkbox"/>	7. Upper Middle Tree Section Placement Stitch	0015	28154	<input type="checkbox"/>	7. Cap Placement Stitch	0015	28154	<input type="checkbox"/>	7. Bottom Placement Stitch	0015	28154				
<input type="checkbox"/>	8. Cut Line & Tackdown	0015	28154	<input type="checkbox"/>	8. Cut Line & Tackdown	0015	28154	<input type="checkbox"/>	8. Cut Line & Tackdown	0015	28154				
<input type="checkbox"/>	9. Top Tree Section Placement Stitch	0015	28154	<input type="checkbox"/>	9. Oval Placement Stitch	0015	28154	<input type="checkbox"/>	9. Bow Placement Stitch	0015	28154				
<input type="checkbox"/>	10. Cut Line & Tackdown	0015	28154	<input type="checkbox"/>	10. Cut Line & Tackdown	0015	28154	<input type="checkbox"/>	10. Cut Line & Tackdown	0015	28154				
<input type="checkbox"/>	11. Star Placement Stitch	0015	28154	<input type="checkbox"/>	11. Cover Stitch	0015	28154	<input type="checkbox"/>	11. Cover Stitch	0015	28154				
<input type="checkbox"/>	12. Cut Line & Tackdown	0015	28154	12525-04 Merry Cane Appliqué											
<input type="checkbox"/>	13. Cover Stitch	0015	28154	<input type="checkbox"/>	1. Section 1 Placement Stitch	0015	28154	<input type="checkbox"/>	1. Heart Placement Stitch	0015	28154				
12525-02 Merry Stocking Appliqué															
<input type="checkbox"/>	1. Cuff Placement Stitch	0015	28154	<input type="checkbox"/>	2. Cut Line & Tackdown	0015	28154	<input type="checkbox"/>	2. Cut Line & Tackdown	0015	28154				
<input type="checkbox"/>	2. Cut Line & Tackdown	0015	28154	<input type="checkbox"/>	3. Section 2 Placement Stitch	0015	28154	<input type="checkbox"/>	3. Heart Left Side Placement Stitch	0015	28154				
<input type="checkbox"/>	3. Sock Top Section Placement Stitch	0015	28154	<input type="checkbox"/>	4. Cut Line & Tackdown	0015	28154	<input type="checkbox"/>	4. Cut Line & Tackdown	0015	28154				
<input type="checkbox"/>	4. Cut Line & Tackdown	0015	28154	<input type="checkbox"/>	5. Section 3 Placement Stitch	0015	28154	<input type="checkbox"/>	5. Heart Right Side Placement Stitch	0015	28154				
<input type="checkbox"/>	5. Sock Middle Section Placement Stitch	0015	28154	<input type="checkbox"/>	6. Cut Line & Tackdown	0015	28154	<input type="checkbox"/>	6. Cut Line & Tackdown	0015	28154				
<input type="checkbox"/>	6. Cut Line & Tackdown	0015	28154	<input type="checkbox"/>	7. Section 4 Placement Stitch	0015	28154	<input type="checkbox"/>	7. Heart Bottom Placement Stitch	0015	28154				
<input type="checkbox"/>	7. Sock Lower Section Placement Stitch	0015	28154	<input type="checkbox"/>	8. Cut Line & Tackdown	0015	28154	<input type="checkbox"/>	8. Cut Line & Tackdown	0015	28154				
<input type="checkbox"/>	8. Cut Line & Tackdown	0015	28154	<input type="checkbox"/>	9. Section 5 Placement Stitch	0015	28154	<input type="checkbox"/>	9. Heart Center Placement Stitch	0015	28154				
<input type="checkbox"/>	9. Heel & Toe Placement Stitch	0015	28154	<input type="checkbox"/>	10. Cut Line & Tackdown	0015	28154	<input type="checkbox"/>	10. Cut Line & Tackdown	0015	28154				
<input type="checkbox"/>	10. Cut Line & Tackdown	0015	28154	<input type="checkbox"/>	11. Section 6 Placement Stitch	0015	28154	<input type="checkbox"/>	11. Cover Stitch	0015	28154				
<input type="checkbox"/>	11. Cover Stitch	0015	28154	<input type="checkbox"/>	12. Cut Line & Tackdown	0015	28154								
12525-03 Merry Ornament Appliqué															
12525-05 Merry Wreath Appliqué															

Note: Optional buttons can be sewn on by hand or machine.

Pre-Cut Appliqué Instructions

1. Print out the necessary pages from the PDF of the appliqué pattern(s).
2. Mark the right side of the pattern pieces so you'll know which direction to lay the pattern on the fabric.
3. Lightly spray the wrong side of the pattern pieces with temporary adhesive spray and allow it to set for a few minutes.
4. Place the pattern pieces on the right side of the fabric and carefully cut them out. **PHOTO 1**
5. Sew the placement stitch on your hooped fabric. **PHOTO 2**
6. With the paper still stuck to the right side of the appliqué fabric, spray the wrong side of the fabric with temporary spray adhesive.
7. Place the fabric inside the sewing placement stitch so that it matches the stitching line, and then remove the paper pattern. **PHOTO 3**
8. Sew the tackdown. **PHOTO 4**
9. Sew the remainder of the design and repeat for any remaining pieces. **PHOTO 5**

NOTE: The patterns are sized for the designs as they were made. If you resize the design, you will need to resize the pattern the same amount. You can print out the pattern at the normal size then copy it on a copy machine at the changed size. For example, resize the designs to 80%, resize the printed pattern to 80%.

TIP: When Printing the patterns, make sure that the “Fit to page” option is **UNCHECKED** in the Print Dialog Box. If this option is checked the printed patterns will not be actual size.

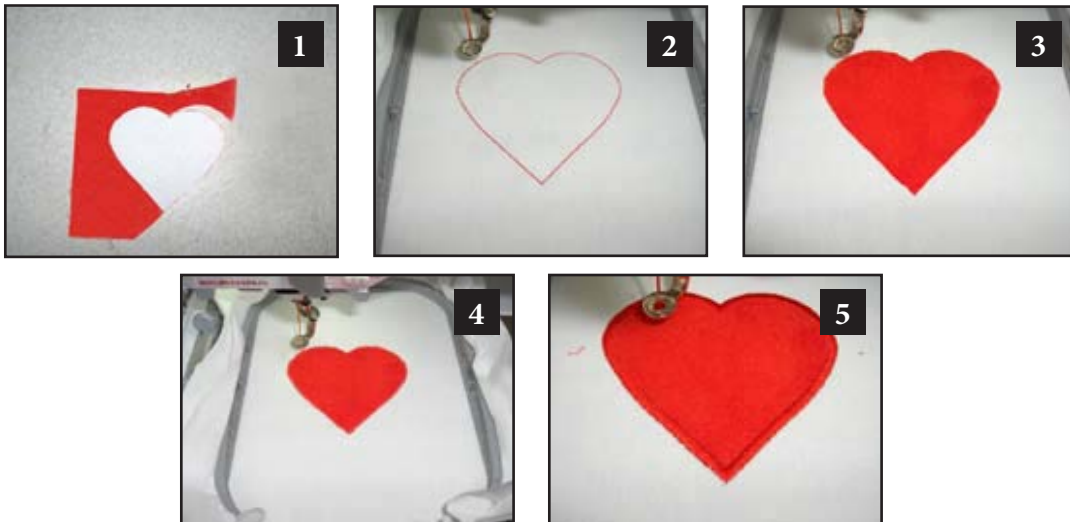

ATTENTION

When printing this document, any page scaling or page fitting options in your print dialog box must be turned OFF or set to NONE so that your files will print out at their actual size. Images not printed at actual size will not function as intended.

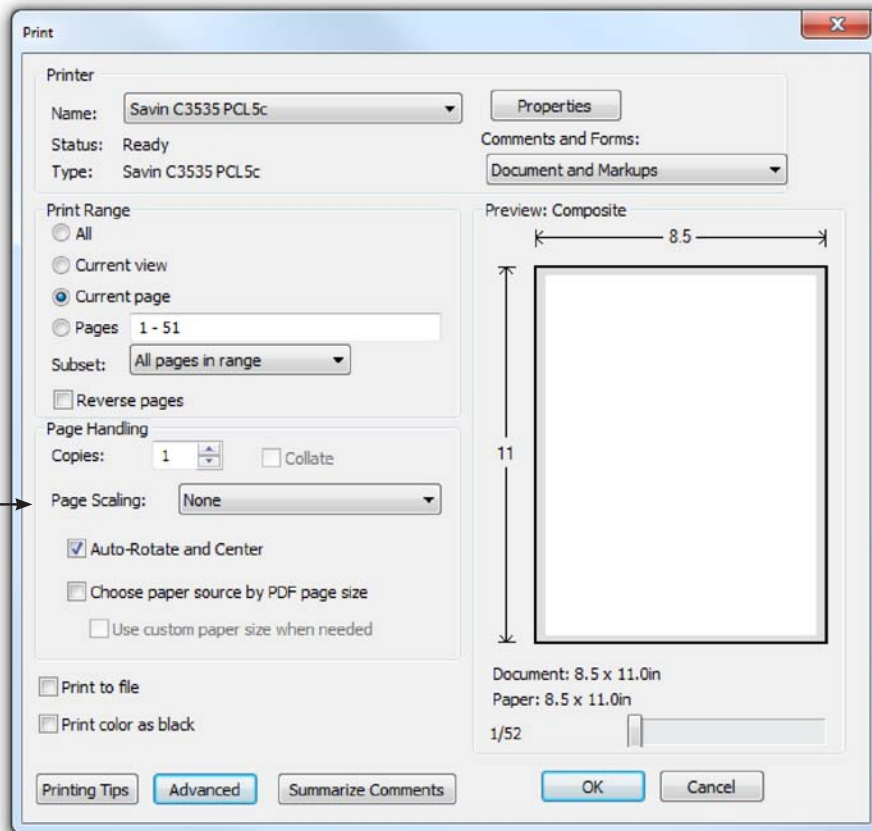

TO SAVE PAPER

Only print the desired image by navigating to the image's page, go to File > Print and select "Current page" in the print dialog box. Repeat for each desired image.

