

# Freestanding Teapot



Collection No. 12975  
1 Design/11 Files

# MATERIALS



## Isacord Thread Colors

- 0020 Black
- 0670 Cream
- 0672 Baquette
- 1010 Toast
- 1322 Dirty Penny
- 1332 Harvest
- 4111 Turquoise
- 4116 Dark Teal
- 4133 Deep Ocean

**Note: One spool of 1000 meter thread is adequate for the project unless otherwise noted.**



# MATERIALS



## Stabilizers

- OESD AquaMesh WashAway
- OESD BadgeMaster WashAway
- OESD StabilStick CutAway
- OESD Fiber Form
- OESD Applique Fuse and Fix

## Fabrics/Textiles

- White quilter's cotton
- Blue quilter's cotton

## Notion & Tools

- OESD Grippy GRID
- OESD Perfect Scoring Tool
- OESD Expert Embroidery Tape TearAway
- OESD Expert Embroidery Tape WashAway
- OESD Perfect Punch Tool
- OESD Mini MAT
- OESD Alligator Clamps
- OESD Button Clips
- OESD Perfect Embroidery Press Cloth
- Embroidery Needle Sharp 75/11 (FSA)
- Embroidery Needle Ballpoint 80/12 (FSL)

## Isacord Thread Colors

- Per the thread chart
- Match bobbin thread to top thread





# SUMMARY



Completed Size:  
With Lid: 8" H x 6 1/4" D x 10.5" W

12975-01

Teapot Section FSA

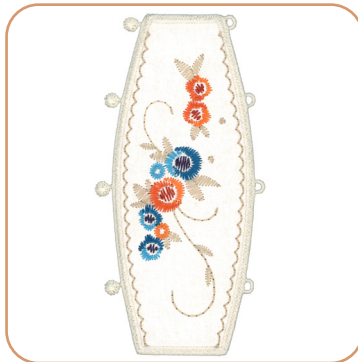

Requires 6 Designs

12975-02

Teapot Spout Section FSA



Requires 1 Design

12975-03

Teapot Handle Section FSA



Requires 1 Design

12975-04

Teapot Bottom FSA

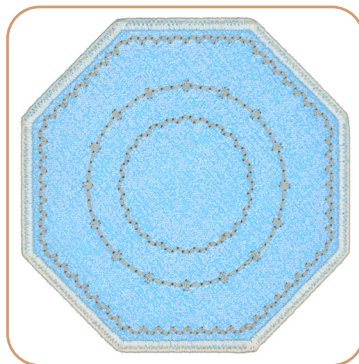

Requires 1 Design

12975-05

Teapot Spout Sides FSA



Requires 1 Design



# SUMMARY

12975-O6

Teapot Spout Top & Bottom FSA

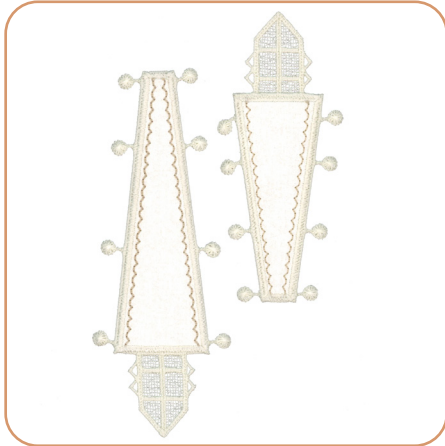

Requires 1 Design

12975-O7

Teapot Handle Sides FSA

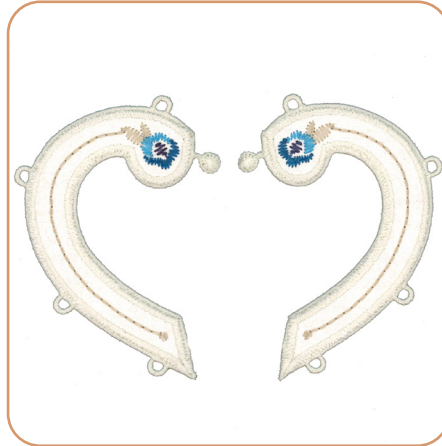

Requires 1 Design

12975-O8

Teapot Handle FSA

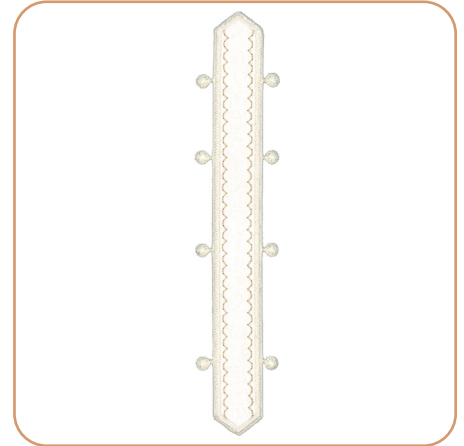

Requires 1 Design

12975-O9

Teapot Lid FSA

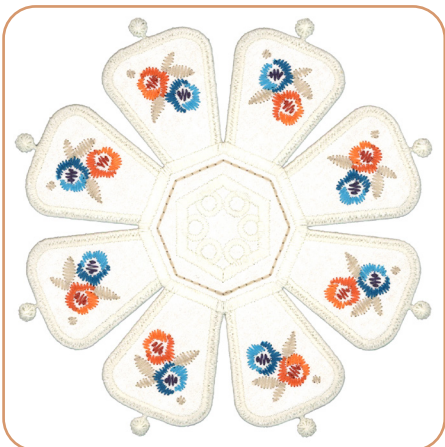

Requires 1 Design

12975-10

Teapot Lid Handle FSA

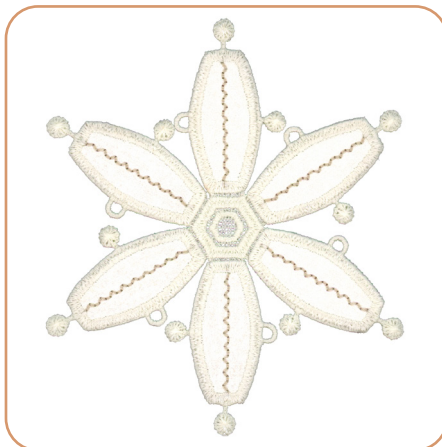

Requires 1 Design

12975-11

Teapot Lid Rim FSL

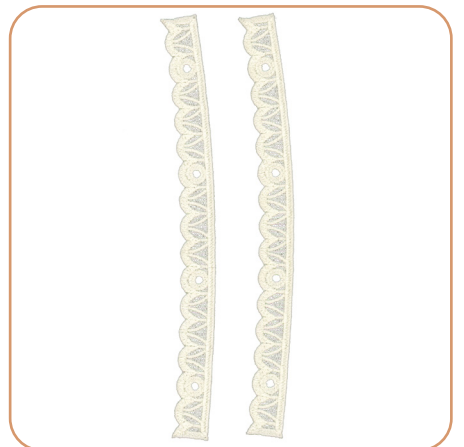

Requires 1 Design

## General Instructions

The freestanding applique instructions, included in the collection, are general instructions. For demonstration purposes, a sample design that best demonstrates the technique is shown. Fabric and thread requirements will vary by design, but the general technique is the same. All designs are stitched with matching thread, top and bobbin.

Note: Some thread colors in instructions have been changed or digitally enhanced for better visibility.

### Step 1

- Print the mirrored version of the templates (at 100% scale or 1:1 ratio) onto the paper side of Applique Fuse and Fix.
- Cut approximately 1/4" - 1/2" outside the printed applique templates.



### Step 2

- Cut the Fiber Form 1/4" - 1/2" larger than the applique templates.
- Fuse the trimmed templates to the back of the Fiber Form with the paper side of the printed template up. Hold the iron on the template for 10-15 seconds for a secure fuse.



### Step 3

- Trim the Fiber Form on the edge of the black outline.
- Set aside.



### Step 4

- Adhere one layer of StabilStick CutAway to the wrong side of all applique fabrics to provide stiffness to the finished structure.
- Cut the prepared applique fabrics 1/4"-1/2" larger than the templates that are included at the end of the instructions.



### Step 5

- Hoop one layer of AquaMesh and one layer of BadgeMaster for all designs.

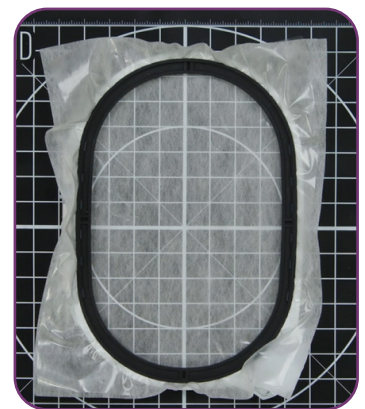



## □ Step 6

- Load selected design into the machine.
- Example design is 12975-01.
- Thread the machine per the thread chart.
- Place the hoop on the machine.
- Stitch Machine Step 1, Fiber Form and Front Fabric Placement Stitch.

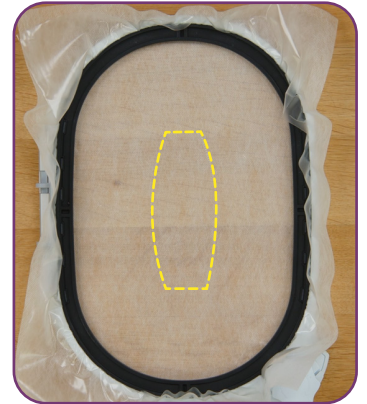

## □ Step 7

- Remove the hoop from the machine, but NOT the project from the hoop.
- Place the hoop on a flat surface.
- On the back of the Fiber Form, use the OESD Perfect Scoring Tool to score and remove the paper backing to reveal the adhesive surface.
- Place the Fiber Form within the placement stitching.
- Finger press to secure.



## □ Step 8

- Completely cover the Fiber Form with the prepared applique fabric.
- Tape in place to secure.



## □ Step 9

- Return the hoop to the machine.
- Stitch Machine Step 2, Cut Line and Tackdown.



## □ Step 10

- Remove the hoop from the machine, but NOT the project from the hoop.
- Trim the excess fabric as close to the cut line as possible. If the outermost stitches (cut line) are cut, the inner stitches (tackdown) will hold the applique in place. Tip: If the stabilizer is cut or a hole is created while trimming the fabric, use OESD Expert Embroidery Tape WashAway as a patch.



## □ Step 11

- Return the hoop to the machine.
- Stitch Machine Steps 3 - 9, changing threads per the thread chart.

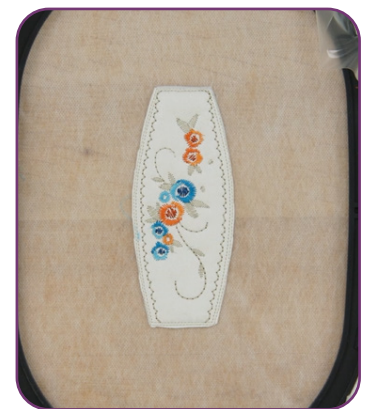

## Step 12

- Remove the hoop from the machine, but NOT the project from the hoop.
- Turn the hoop over and place the prepared applique fabric, right side up, completely covering the placement stitch.
- Carefully tape to secure.  
Tip: Avoid pushing too hard on the stabilizer to prevent it from dislodging from the hoop.



## Step 13

- Return the hoop to the machine.
- Stitch Machine Step 10, Back Fabric Cut Line and Tackdown.



## Step 14

- Remove the hoop from the machine, but NOT the project from the hoop.
- Trim the excess fabric as close to the cut line as possible.





## □ Step 15

- Return the hoop to the machine.
- Stitch Machine Step 11, Cover Stitch and Lace.



## □ Step 16

- When the design is complete, remove the project from the hoop and trim the stabilizer 1/4" - 1/2" outside the design.

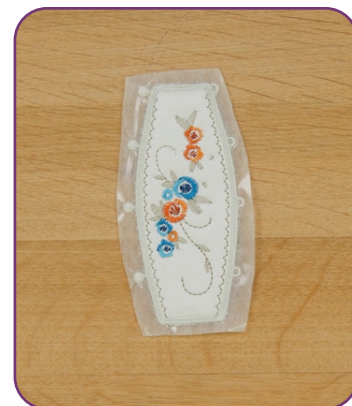

# GENERAL FREESTANDING LACE GUIDE



## Stabilizer

- OESD AquaMesh
- OESD BadgeMaster

## Notion/Tools

- 80/12 Embroidery Ballpoint Titanium needle for extended needle life
- OESD Alligator Clamps
- OESD Button Clips
- OESD Perfect Point and Press Tool

## Isacord Thread Colors

- All OESD designs are digitized with Isacord 40 wt. polyester thread as the top thread and in the bobbin.
- Refer to the thread chart for color specifications.
- Match bobbin thread color to the top thread.

## Instructions

### Step 1 - Hoop

For FSL structures, hoop one layer of OESD AquaMesh and one layer of OESD BadgeMaster. BadgeMaster contains more starch so, combined with the AquaMesh, the lace is more rigid. For other FSL, where a softer lace is desired, hoop two layers of AquaMesh.

### Step 2 - Embroider

Stitch the design per the thread chart with matching thread in the bobbin at each color change. When complete, remove from the hoop and trim away excess stabilizer about 1/4"-1/2" from the stitching.

### Step 3 - Rinse

Rinse remaining stabilizer out in warm running water. For stiffer lace and FSL structures, DO NOT rinse away all of the stabilizer. The lace should be just slightly tacky. For softer lace, rinse until all traces of the stabilizer is removed.

### Step 4 - Dry

Lay right side down flat on a non-stick surface, such as a cookie rack, parchment paper or Teflon sheet. This minimizes the tendency for the lace to curl. Let the pieces dry completely before proceeding with any assembly.

### Step 5 - Press

Once completely dry, press right side down on a OESD Perfect Embroidery Press Cloth.

### Step 6 - Assemble Structure

Note: Specific assembly instructions for a design/collection may be found in the thread chart pdf following the individual design color charts. Lace must be COMPLETELY DRY before assembly. Wetting the buttonettes or eyelets to assemble is not recommended and may result in them stretching and coming "unbuttoned" when dry. Use a pair of OESD Alligator Clamps to insert the buttonettes into the eyelets. Insert the tip of the OESD Alligator Clamps into the eyelet, grasp the buttonette and pull through the eyelet. Alternatively, use a stiletto or tweezers to push the buttonette through the eyelet.

## Helpful Tips

### Limp Lace

If the design is not stiff enough, press the lace pieces on the wrong side while applying spray starch. After ironing, spray again with starch and allow to dry completely. This will stiffen the lace pieces nicely and aid in construction. Or easily re-stiffen by diluting some stabilizer scraps in water (or use liquid starch) and dipping the item in the solution. Lay flat to dry.

### Eyelets Too Small

If any of the eyelets appear closed or too small to penetrate with Alligator Clamps, they may be stretched by inserting the small end of the OESD Perfect Point and Press Tool into the eyelet opening and stretching it open wide enough to accommodate the OESD Alligator Clamps.

### Button Clips

During the assembly process, some structures pull on buttonettes that have already been inserted and could pull them out altogether. Putting a Button Clip on the assembled buttonette will keep it in position during the assembly process. Remove the Button Clips when the assembly is complete.

### Alternative Construction Option

In some cases, the buttonettes may be pulled to the inside of a project, instead of being visible on the outside. Insert the OESD Alligator Clamps through the eyelet from the wrong, or inside, of the lace and grasp the corresponding buttonette. Pull the buttonette to the wrong side of the lace. Pulling the buttonettes to the inside may cause stress on the ones already done. Button clips may be placed on the completed buttonette(s) to prevent them from pulling out of the eyelet.

## Step 17

- Design 12975-10
- Print the mirrored version of the templates (at 100% scale or 1:1 ratio) onto the paper side of Applique Fuse and Fix.
- Cut approximately 1/4" - 1/2" outside the printed applique templates.

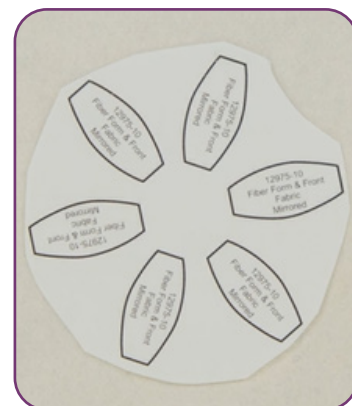

## Step 18

- Cut the Fiber Form 1/4"-1/2" larger than the applique templates.
- Fuse the trimmed templates to the back of the Fiber Form with the paper side of the printed template up. Hold the iron on the template for 10-15 seconds for a secure fuse.

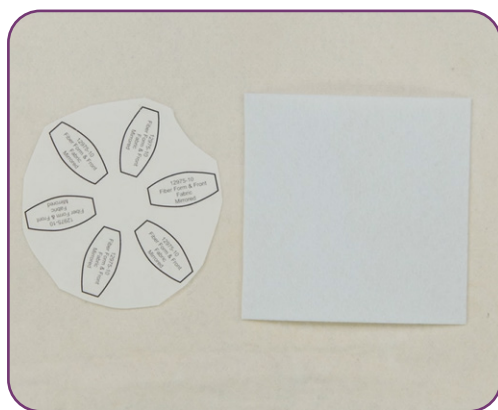



## □ Step 19

- Trim the Fiber Form on the edge of the black outline.
- Set aside.



## □ Step 20

- Cut the prepared applique fabric 1/4" -1/2" larger than the templates that are included at the end of the instructions.
- Adhere one layer of StabilStick CutAway to the wrong side of all applique fabric, to provide stiffness to the finished structure.

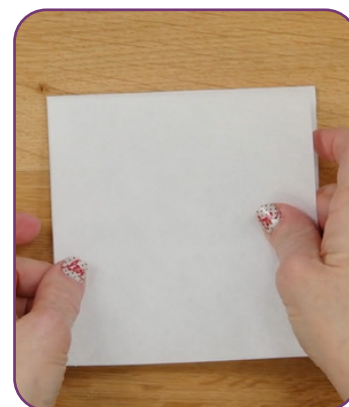

## □ Step 21

- Hoop one layer of AquaMesh and one layer of BadgeMaster for all designs.

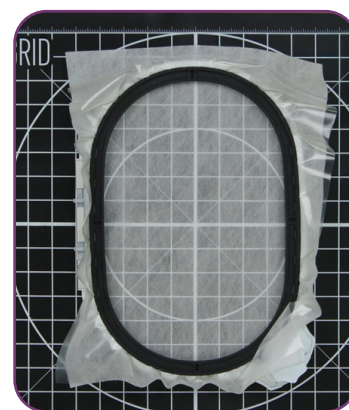

## □ Step 22

- Load selected design into the machine.
- Example design is 12975-10.
- Thread the machine per the thread chart.
- Place the hoop on the machine.
- Stitch Machine Step 1, Fiber Form and Front Fabric Placement Stitch.

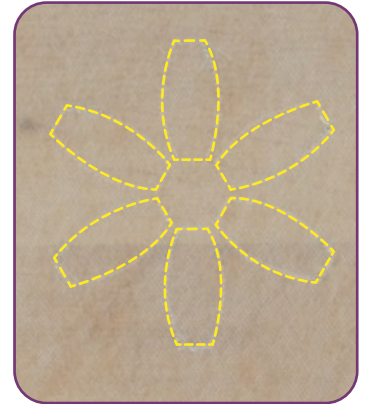

## □ Step 23

- Remove the hoop from the machine, but NOT the project from the hoop.
- Place the hoop on a flat surface.
- On the back of the Fiber Form, score and remove the paper backing to reveal the adhesive surface.
- Place the Fiber Form within the placement stitching.
- Finger press to secure.

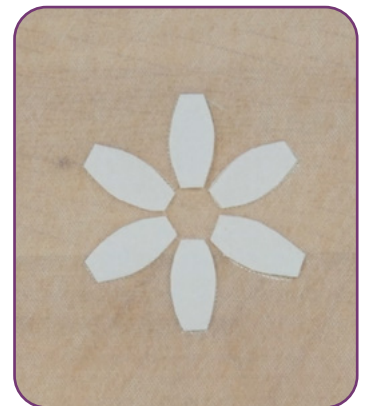

## □ Step 24

- Completely cover the Fiber Form and the placement stitch with the prepared fabric.
- Tape in place to secure.

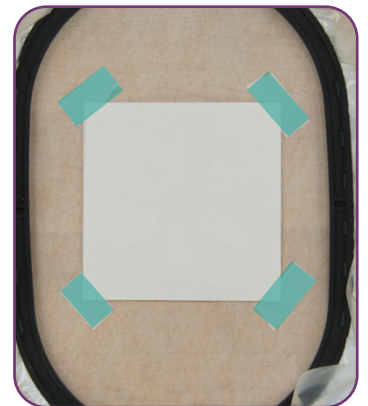

## □ Step 25

- Return the hoop to the machine.
- Stitch Machine Step 2, Cut Line and Tackdown.

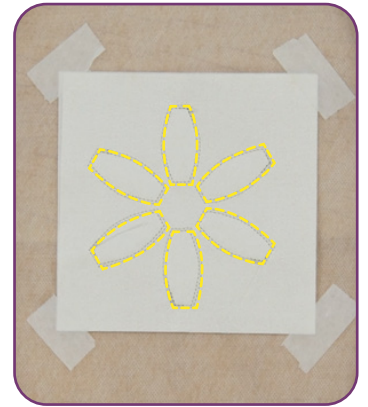

## □ Step 26

- Remove the hoop from the machine, but NOT the project from the hoop.
- Place the hoop on a flat surface.
- Trim the excess fabric as close to the cut line stitching as possible.
- **Note:** If the outermost stitches (cut line) are cut, the inner stitches (tackdown) will hold the applique in place.

Tip: If the stabilizer is cut or a hole is created while trimming the fabric, use OESD Expert Embroidery Tape WashAway as a patch.





## □ Step 27

- Return the hoop to the machine and stitch the remaining steps per the thread chart.
- Match the bobbin thread to the upper thread.



## □ Step 28

- When the design is complete, remove the project from the hoop and trim the stabilizer 1/4" - 1/2" outside the design.



# ASSEMBLY

## □ Step 29

- Rinse each piece in warm running water until the design is only slightly tacky.
- Place right side down on a non-stick surface to dry. Parchment paper or a cooling rack work well to prevent curling. Dry completely.
- Once dry, press right side down on a Perfect Embroidery Press Cloth.



## □ Step 30

- Use the OESD Mini MAT and Punch Tool with the 3mm attachment to create the eyelets indicated in the diagram.
- Use the Mini MAT and a craft knife to cut through all the layers of the tab entries.
- Tip: Take care to not cut the satin stitching.
- Reference the Punch Tool Guide on page 25.

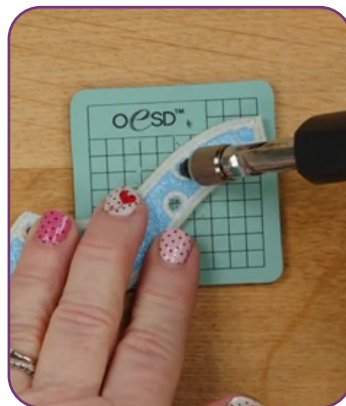

# ASSEMBLY

## □ Step 31

- To connect the side pieces to the bottom, line up 3 (12975-01), 1 (12975-02), 3 (12975-01) and 1 (12975-03) right side up as shown.
- Place the bottom piece 12975-04 right side (blue) facing down in the center of the side pieces.
- Thread the sewing machine with matching thread on the top and bobbin.
- Stitch together using a multi-step zigzag stitch.
- Back stitch at the beginning and end to secure.
- Trim thread tails.
- Fold and press into shape.

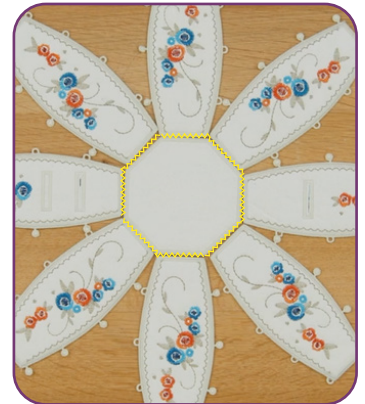

## □ Step 32

- To connect the Teapot Lid Rim 12975-11, align the two pieces of lace, right sides up as shown.
- Stitch together using a multi-step zigzag stitch.
- Back stitch at the beginning and end to secure.
- Stitch the other ends together to form a circle.
- Set aside.

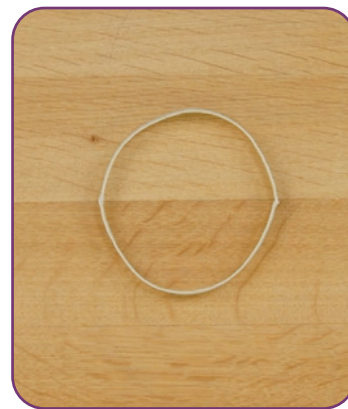
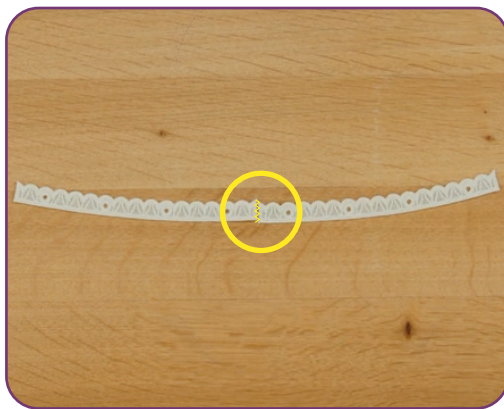

## □ Step 33

- Starting at the bottom, match the buttonettes of the teapot sides to the corresponding eyelets.
- Pull the two bottom sets of buttonettes through the eyelets all the way around the teapot.
- Use Alligator Clamps to pull each buttonette through the corresponding eyelet, using button clips to temporarily hold them in place, as needed.
- Set it aside.

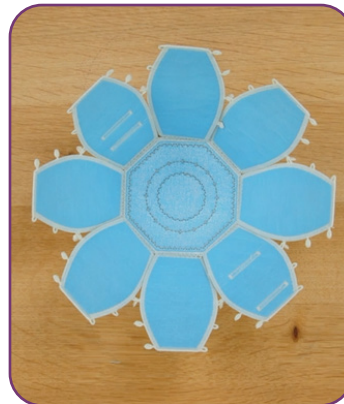
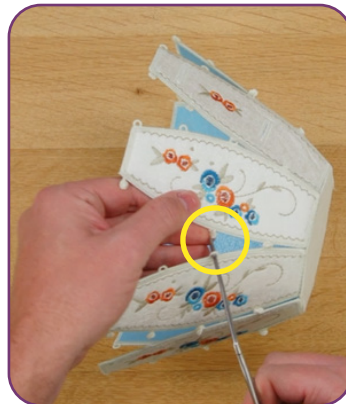

## □ Step 34

- Match the buttonettes of the Teapot Spout Sides FSA (12975-05) to the eyelets of the Teapot Spout Top & Bottom (12975-06) as shown.
- Pull each buttonette through the corresponding eyelet.

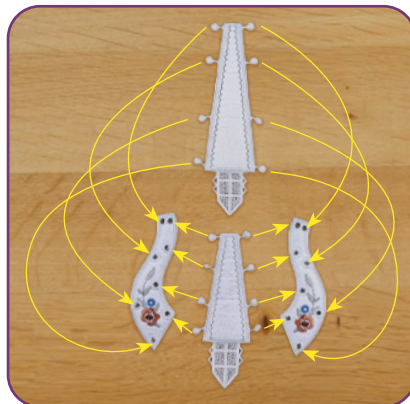



# ASSEMBLY

## □ Step 35

- Insert the interlocking tabs of the Spout assembly into the tab entries in Teapot Spout Section FSA (12975-02).

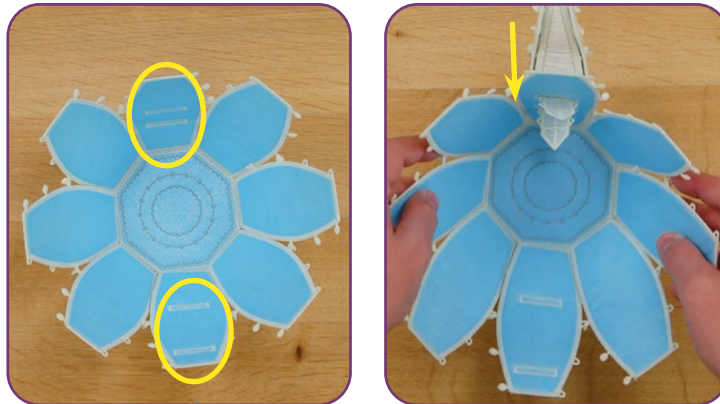

## □ Step 36

- Match the buttonettes of the Teapot Handle Sides FSA (12975-07) to the eyelets of the Teapot Handle FSA (12975-08).
- Pull each buttonette through the corresponding eyelet.

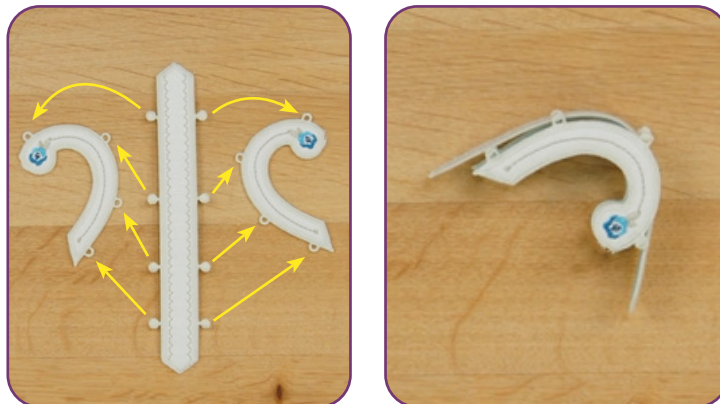

# ASSEMBLY

## □ Step 37

- Insert the interlocking tabs of the Handle assembly into the tab entries in Teapot Handle Section FSA (12975-03).

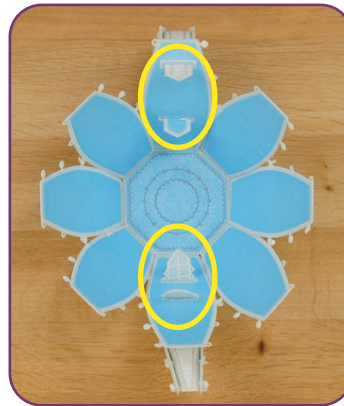
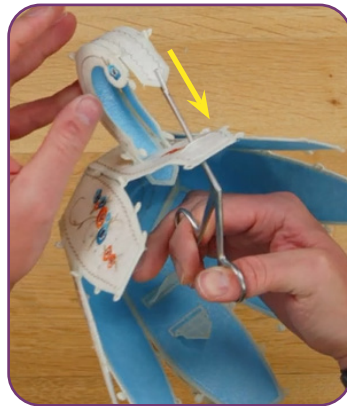

## □ Step 38

- Match the remaining buttonettes of the Teapot assembly to the corresponding eyelets.
- Pull each buttonette through the corresponding eyelet.
- Note: The top set of buttonettes need to be pulled to the inside of the project to allow the Teapot Lid to sit correctly.

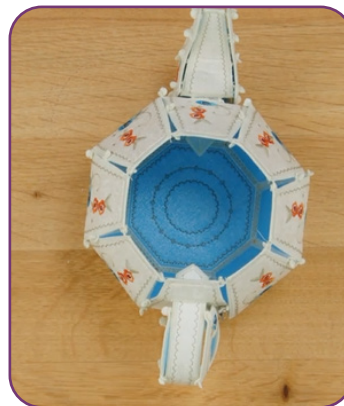

## □ Step 39

- Bend and fold Teapot Lid FSA (12975-09) into shape and match the buttonettes to the corresponding eyelets in the Teapot Lid Rim FSL (12975-11).
- Pull each buttonette through the corresponding eyelet.

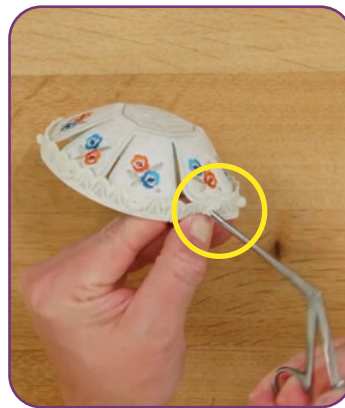

## □ Step 40

- Bend and fold Teapot Lid Handle FSA (12975-10) and match the buttonettes to the corresponding eyelets.
- Pull each buttonette through the corresponding eyelet.

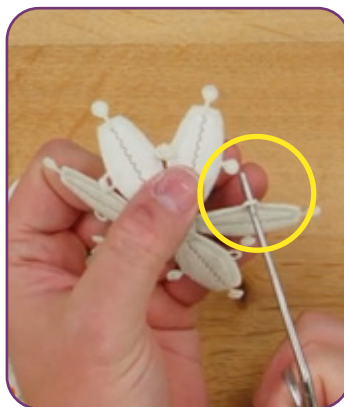

# ASSEMBLY

## Step 41

- Pull the buttonettes of the Teapot Lid Handle FSA (12975-10) through the matching eyelets in the Teapot Lid assembly.

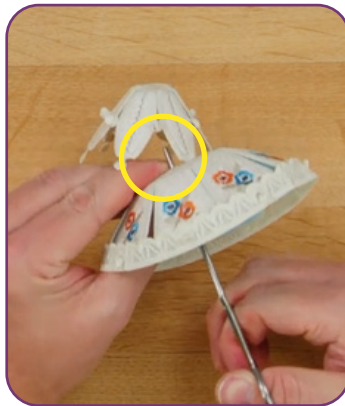

## Step 42

- Place the Lid onto the Teapot.
- The project is complete. Enjoy!

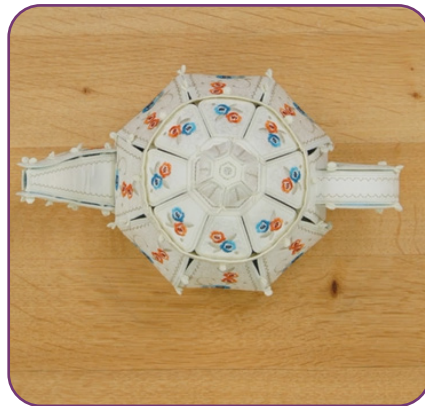



# PUNCH TOOL GUIDES



12975-02

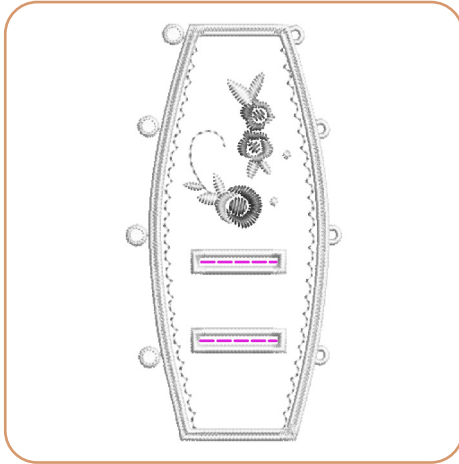

12975-03



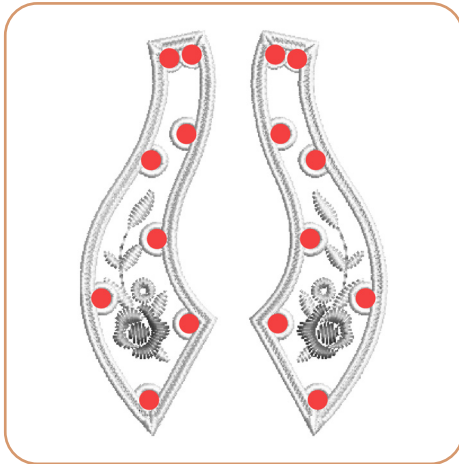

12975-05



12975-09



 = 2 MM

 = 3 MM

 = 4 MM

CRAFT KNIFE



## ATTENTION

When printing this document, any page scaling or page fitting options in your print dialog box must be turned OFF or set to NONE so that your files will print out at their actual size. Images not printed at actual size will not function as intended.

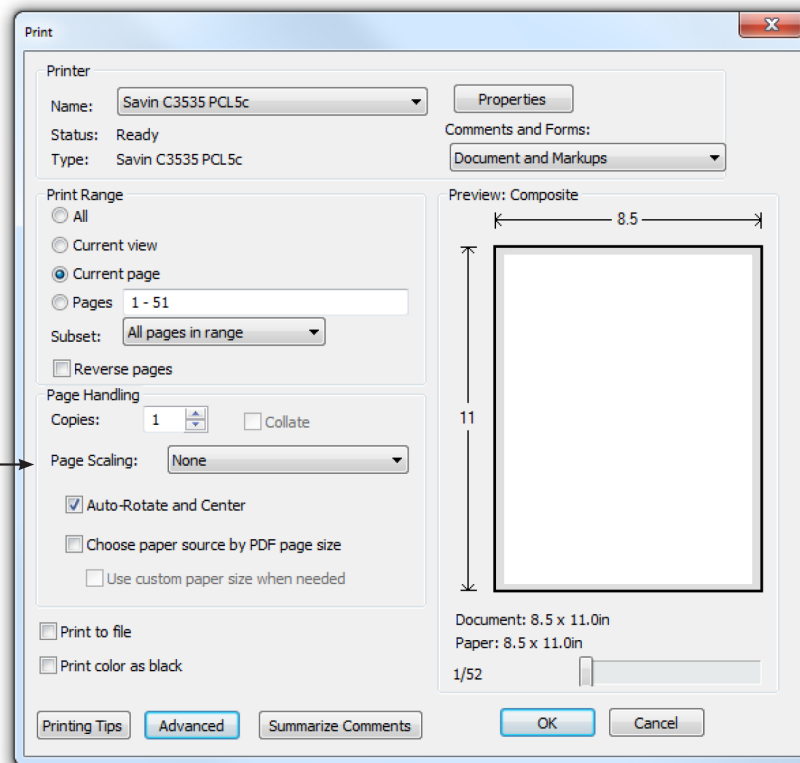

## TO SAVE PAPER

Only print the desired image by navigating to the image's page, go to File > Print and select "Current page" in the print dialog box. Repeat for each desired image.

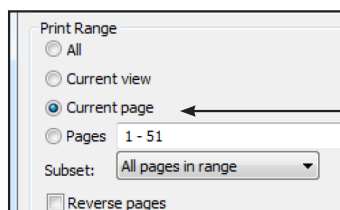

# APPLIQUE PATTERNS

**OESD**<sup>TM</sup> **PREMIER**  
COLLECTION

Print at 100%. No scaling. This box measures 1" x 1". Use the box as an accuracy guide when printing templates.

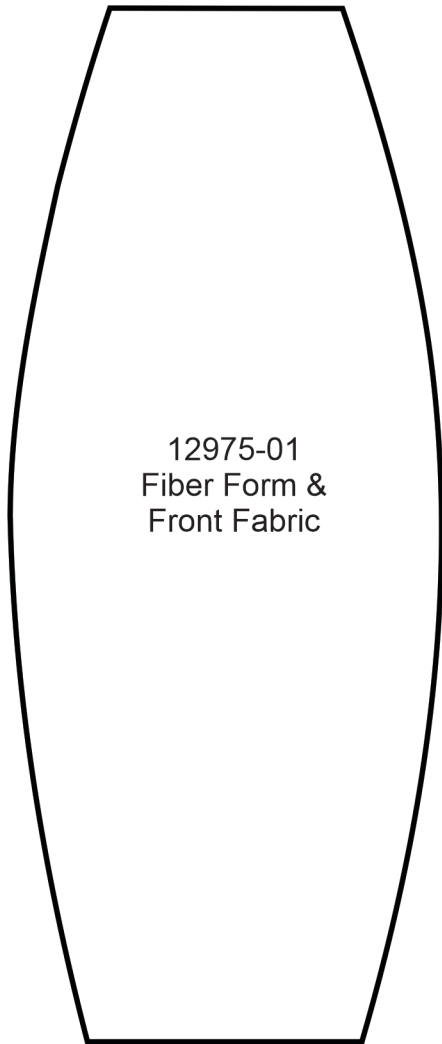

# APPLIQUE PATTERNS



Print at 100%. No scaling. This box measures 1" x 1". Use the box as an accuracy guide when printing templates.

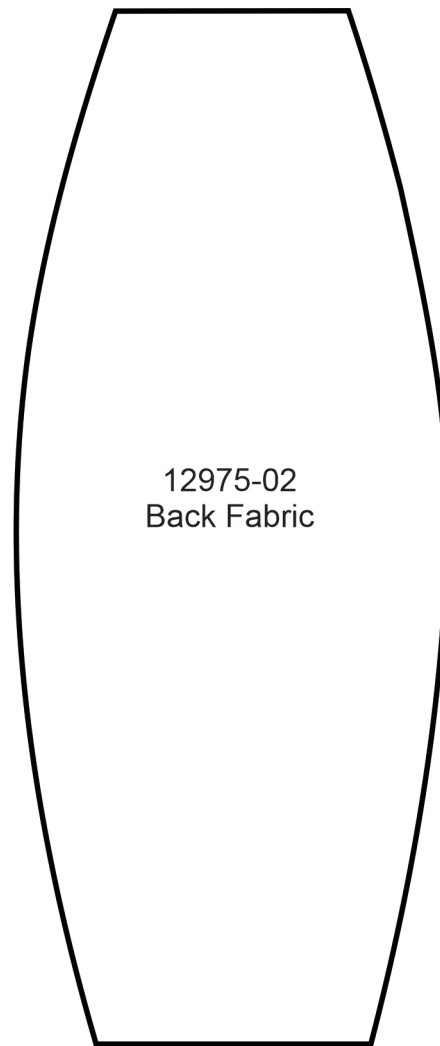
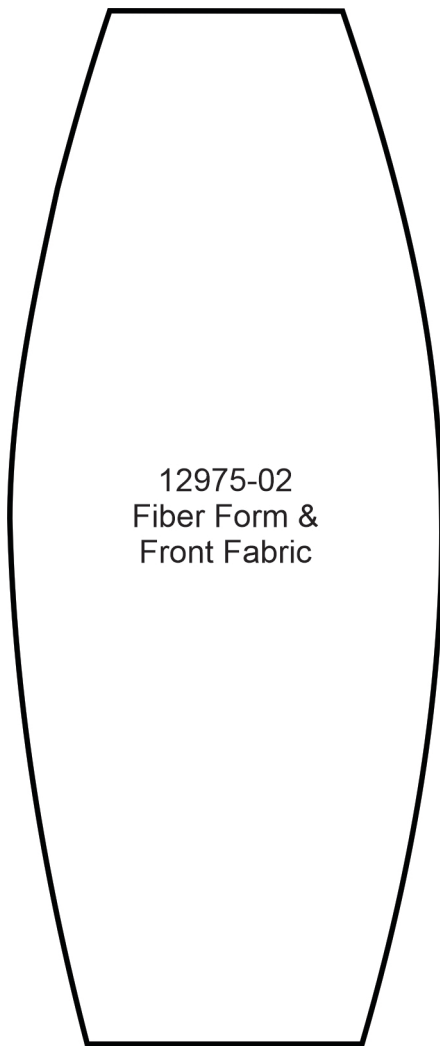



# APPLIQUE PATTERNS



Print at 100%. No scaling. This box measures 1" x 1". Use the box as an accuracy guide when printing templates.

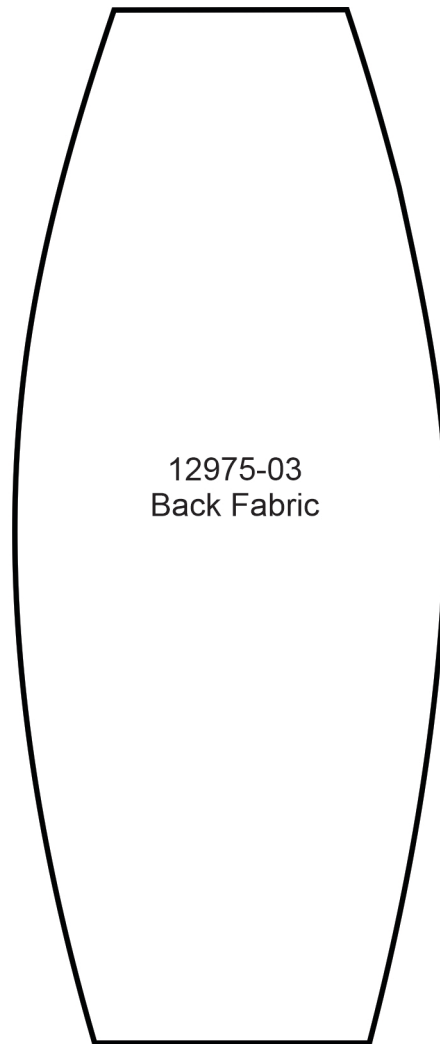
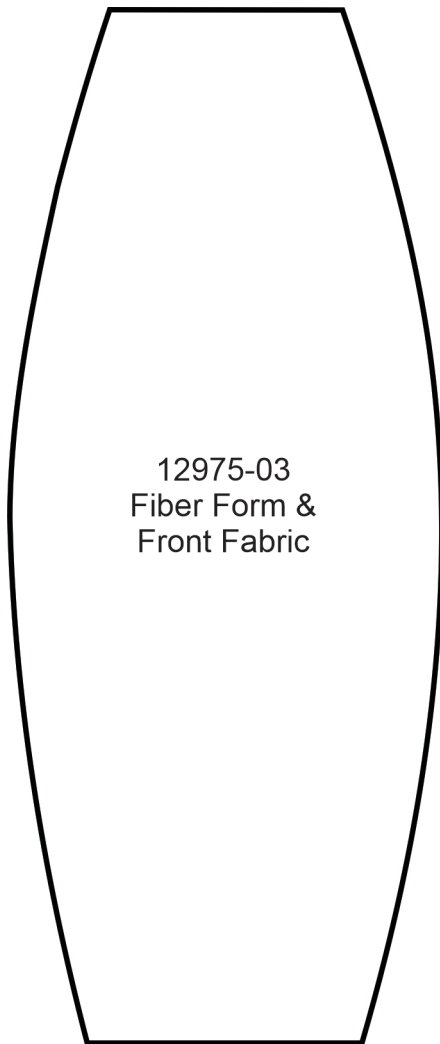

# APPLIQUE PATTERNS

Print at 100%. No scaling. This box measures 1" x 1". Use the box as an accuracy guide when printing templates.

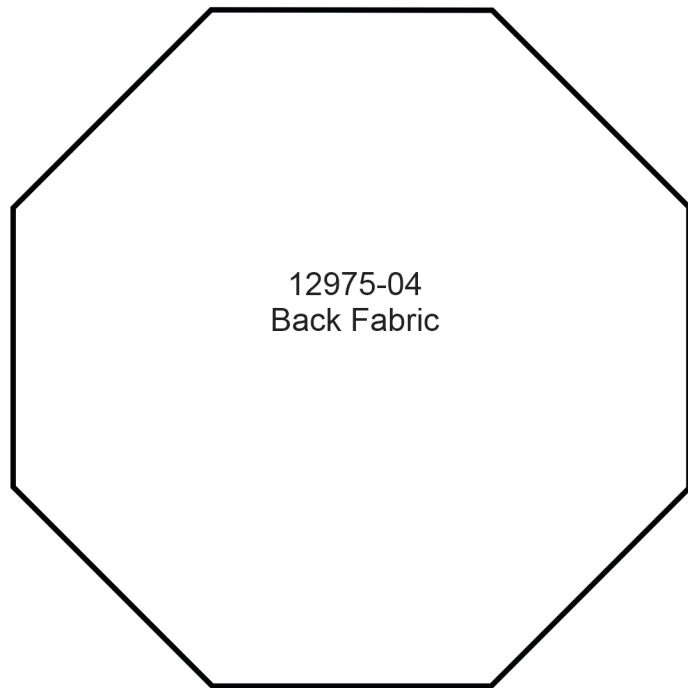
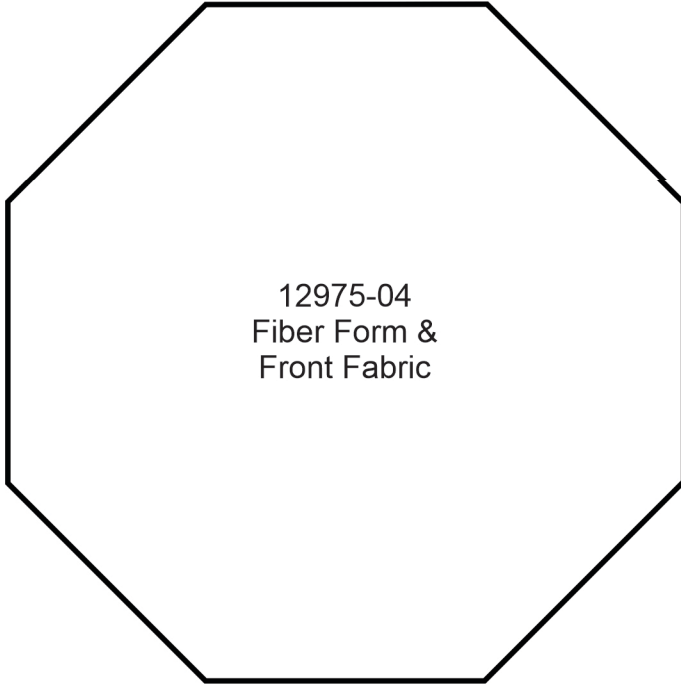

# APPLIQUE PATTERNS



Print at 100%. No scaling. This box measures 1" x 1". Use the box as an accuracy guide when printing templates.

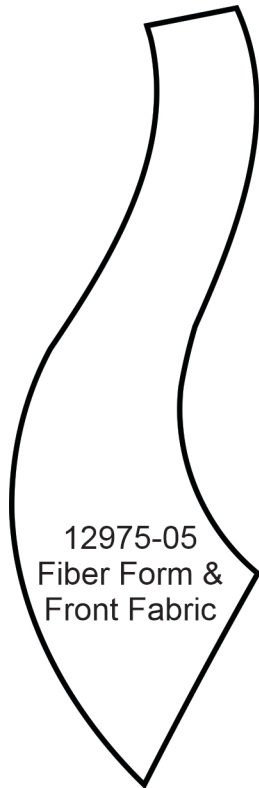

12975-05  
Fiber Form &  
Front Fabric

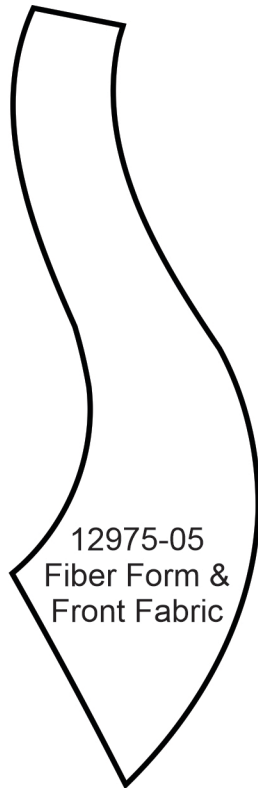

12975-05  
Fiber Form &  
Front Fabric

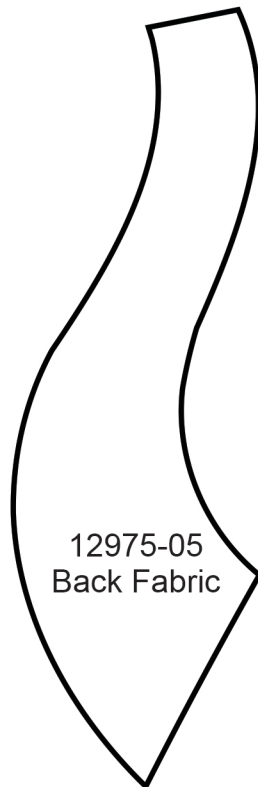

12975-05  
Back Fabric

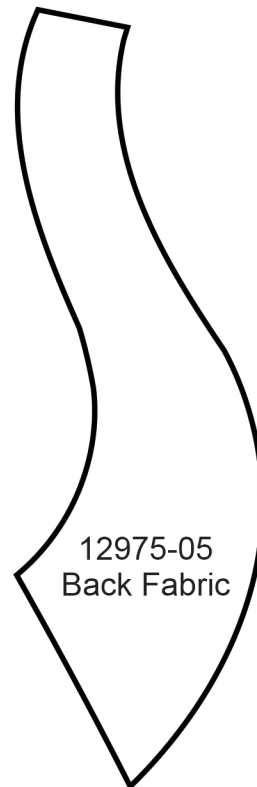

12975-05  
Back Fabric

# APPLIQUE PATTERNS

Print at 100%. No scaling. This box measures 1" x 1". Use the box as an accuracy guide when printing templates.

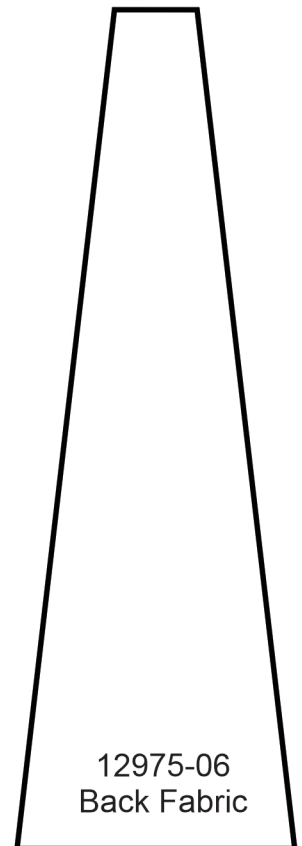
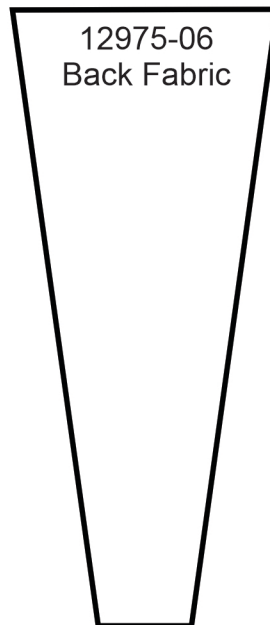
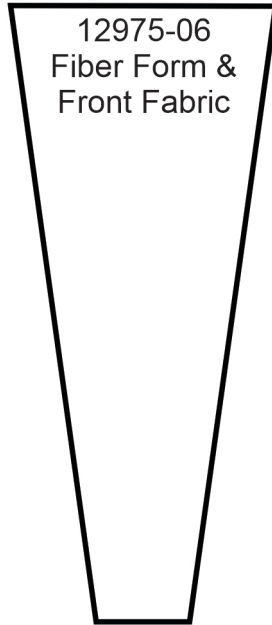
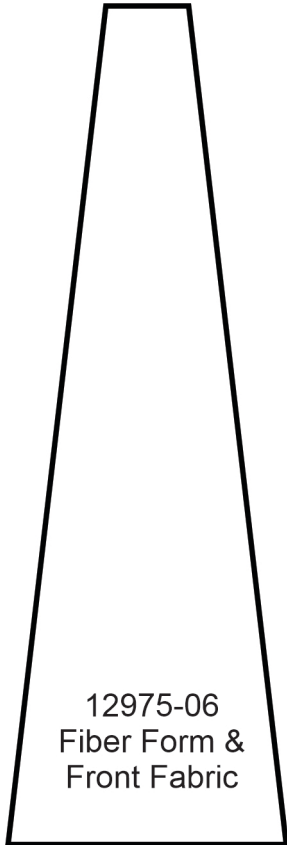



# APPLIQUE PATTERNS

Print at 100%. No scaling. This box measures 1" x 1". Use the box as an accuracy guide when printing templates.

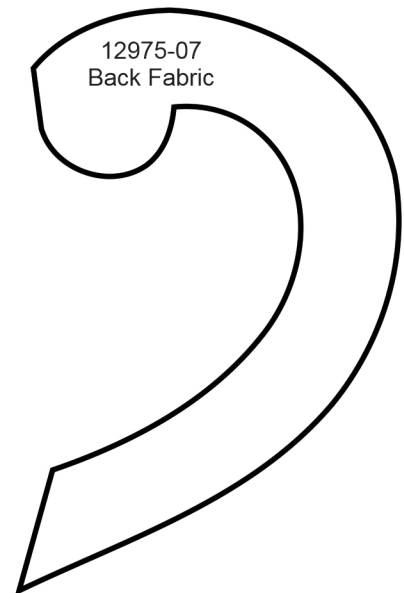
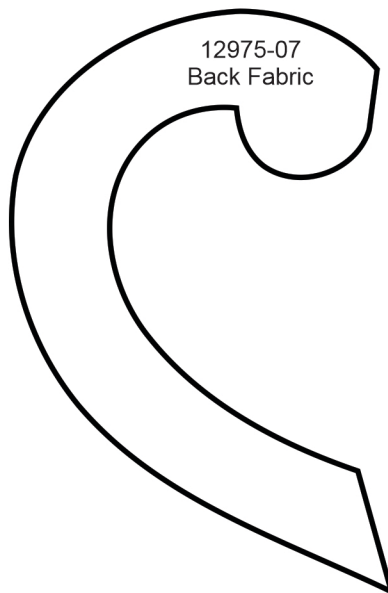
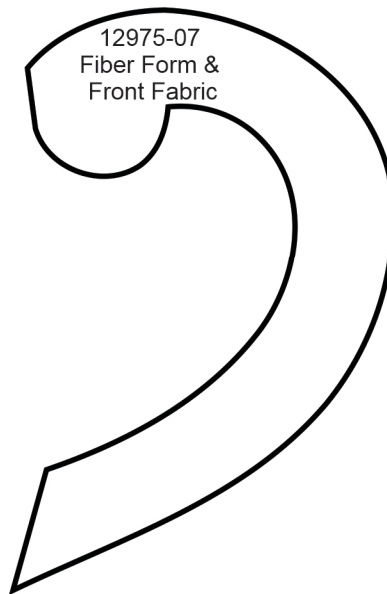
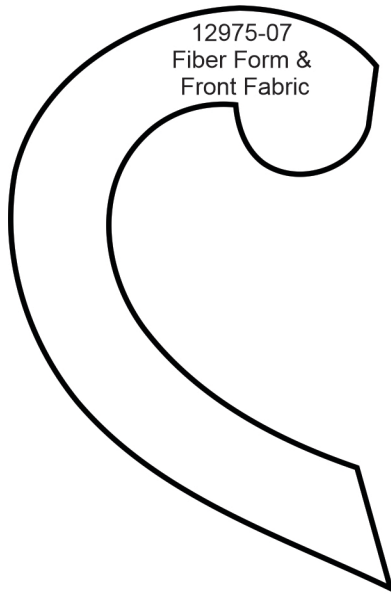

# APPLIQUE PATTERNS

Print at 100%. No scaling. This box measures 1" x 1". Use the box as an accuracy guide when printing templates.

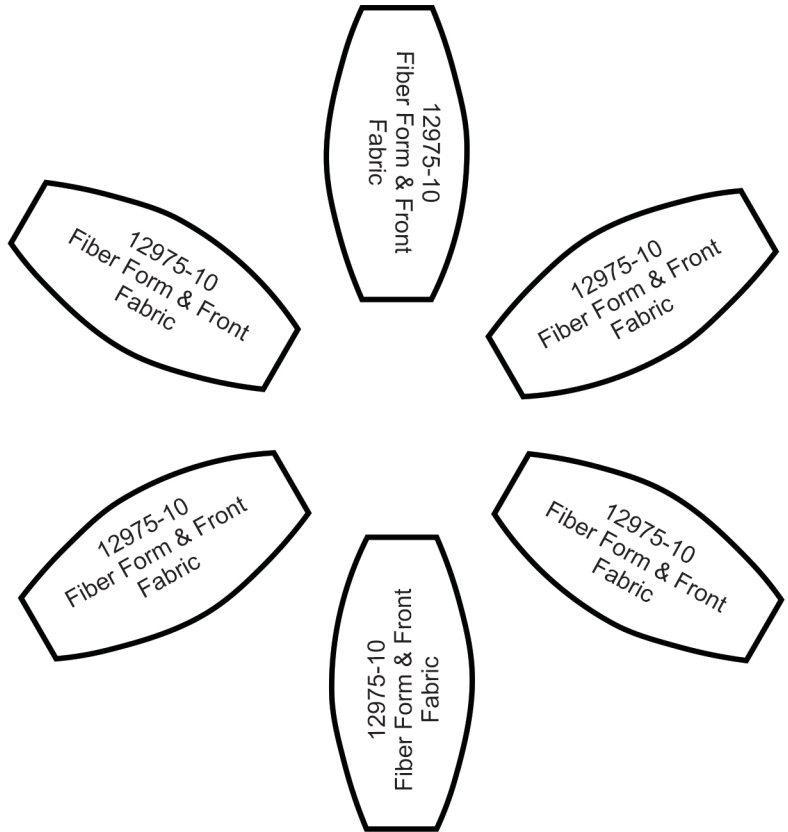

# APPLIQUE PATTERNS

**OESD**<sup>TM</sup> **PREMIER**  
COLLECTION

Print at 100%. No  
scaling. This box  
measures 1" x 1".  
Use the box as an  
accuracy guide  
when printing  
templates.

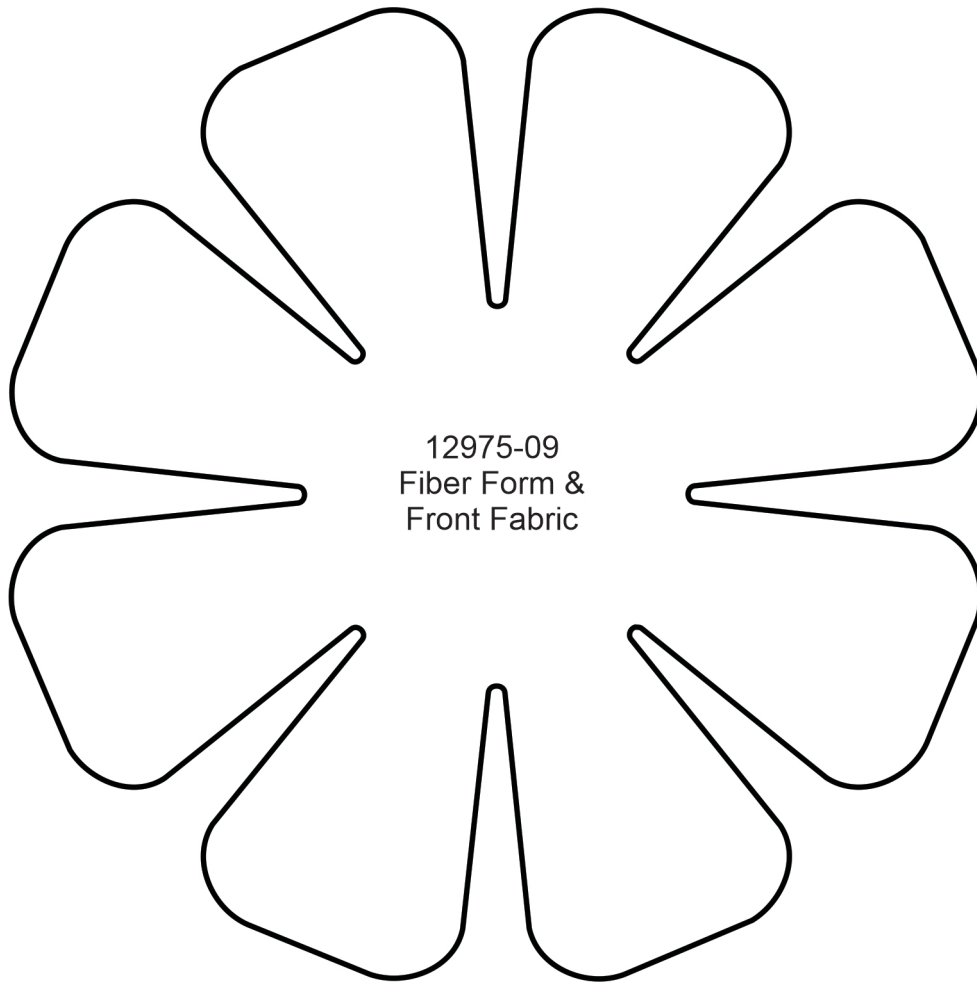

# APPLIQUE PATTERNS

OESD™ PREMIER  
COLLECTION

Print at 100%. No  
scaling. This box  
measures 1" x 1".  
Use the box as an  
accuracy guide  
when printing  
templates.

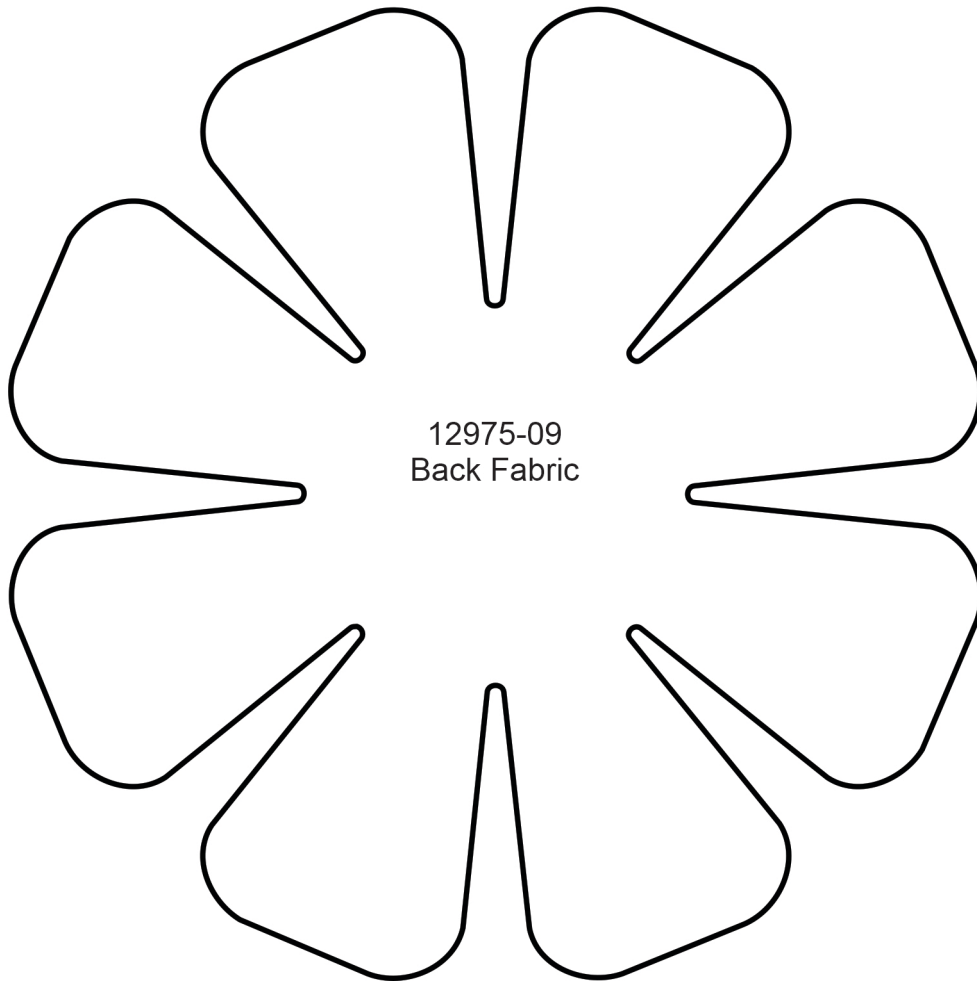



# MIRRORED PATTERNS



Print at 100%. No scaling. This box measures 1" x 1". Use the box as an accuracy guide when printing templates.

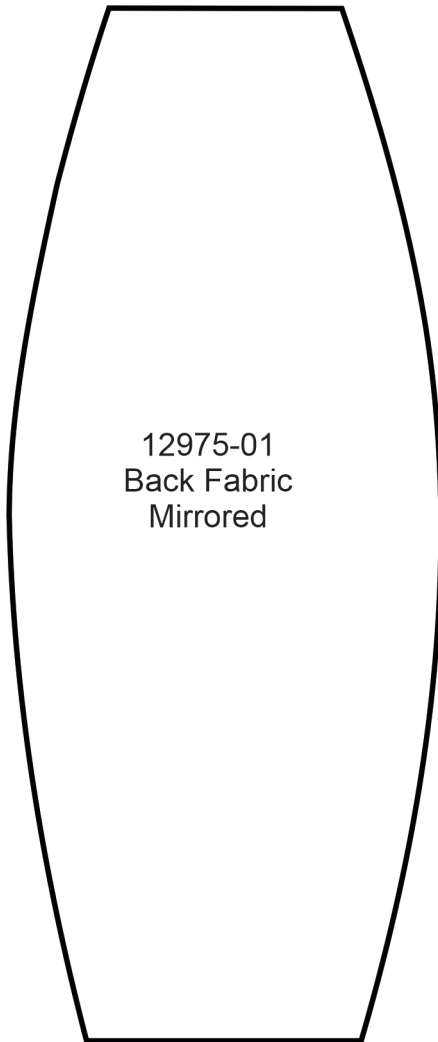

12975-01  
Back Fabric  
Mirrored

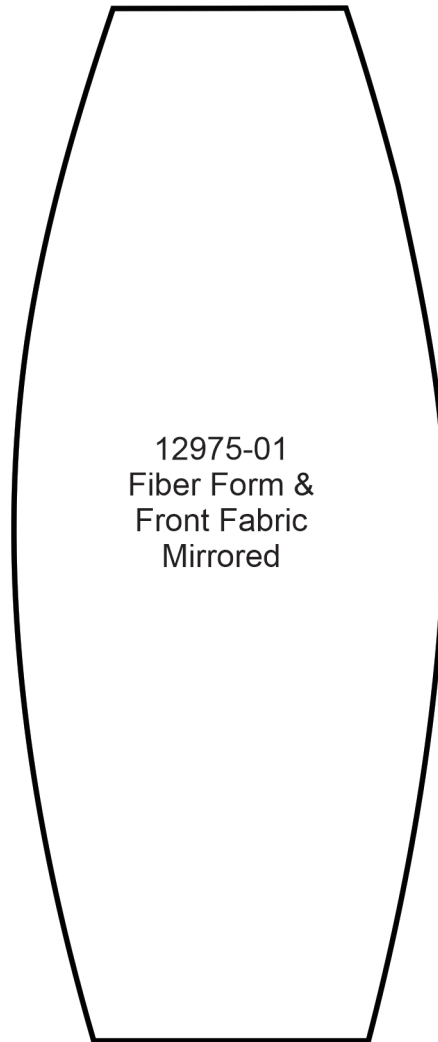

12975-01  
Fiber Form &  
Front Fabric  
Mirrored

# MIRRORED PATTERNS



Print at 100%. No scaling. This box measures 1" x 1". Use the box as an accuracy guide when printing templates.

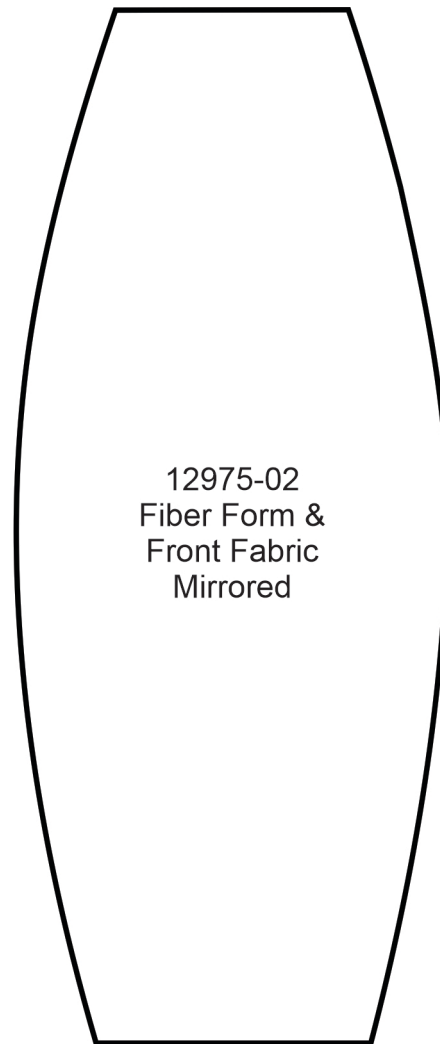

# MIRRORED PATTERNS PREMIER COLLECTION

Print at 100%. No scaling. This box measures 1" x 1". Use the box as an accuracy guide when printing templates.

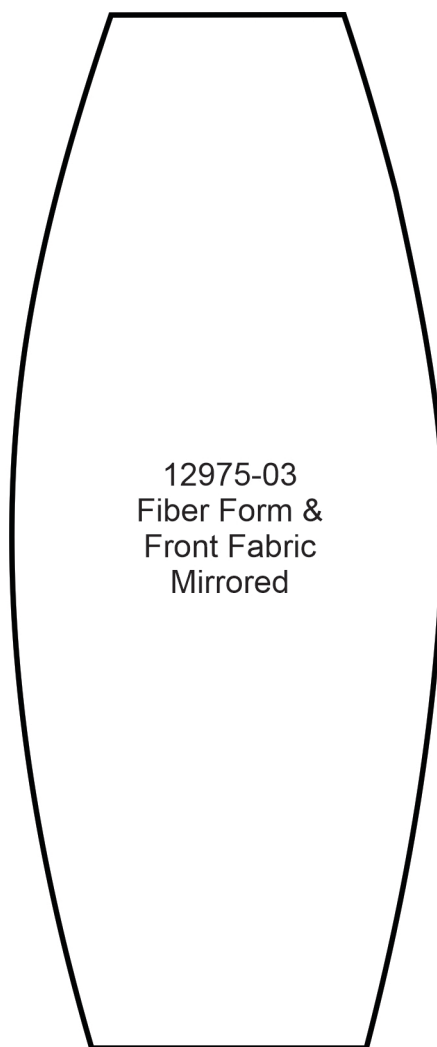

# MIRRORED PATTERNS PREMIER COLLECTION

Print at 100%. No scaling. This box measures 1" x 1". Use the box as an accuracy guide when printing templates.



# MIRRORED PATTERNS



Print at 100%. No scaling. This box measures 1" x 1". Use the box as an accuracy guide when printing templates.

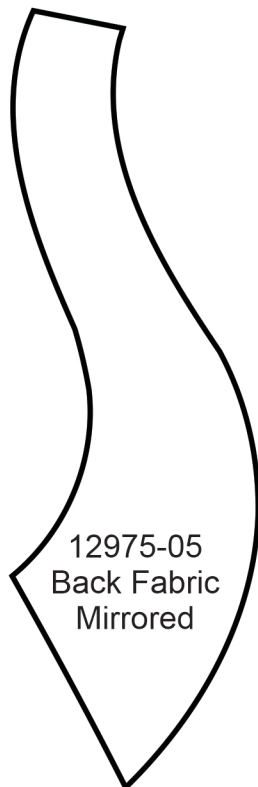
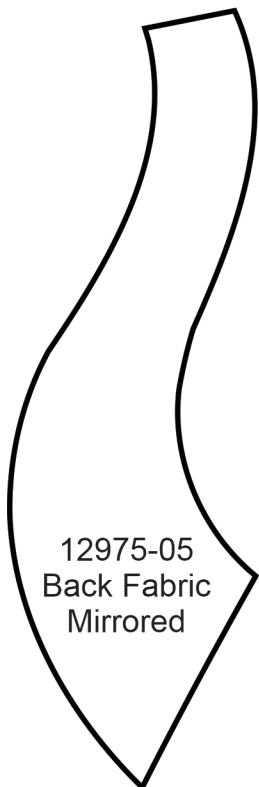
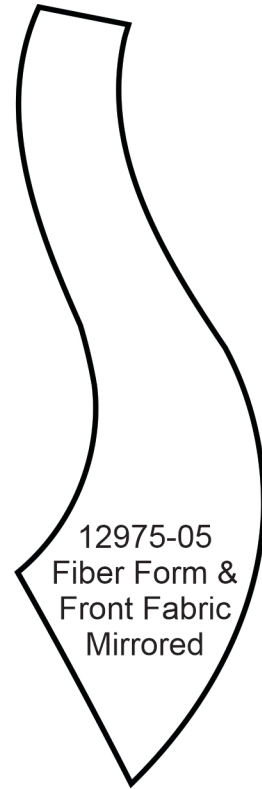
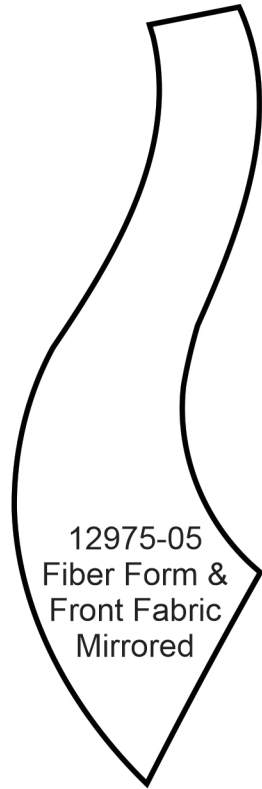



# MIRRORED PATTERNS



Print at 100%. No scaling. This box measures 1" x 1". Use the box as an accuracy guide when printing templates.

12975-06  
Fiber Form &  
Front Fabric  
Mirrored

12975-06  
Fiber Form &  
Front Fabric  
Mirrored

12975-06  
Back Fabric  
Mirrored

12975-06  
Back Fabric  
Mirrored

# MIRRORED PATTERNS



Print at 100%. No scaling. This box measures 1" x 1". Use the box as an accuracy guide when printing templates.

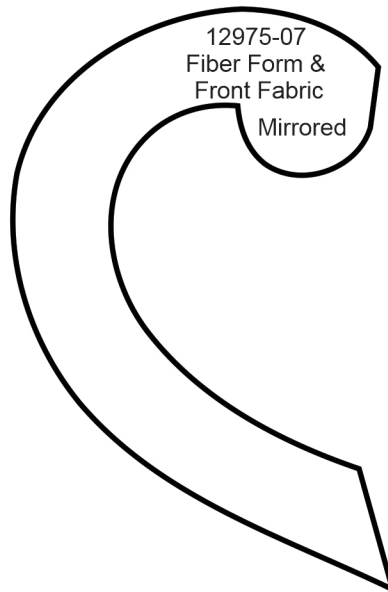

12975-07  
Fiber Form &  
Front Fabric  
Mirrored

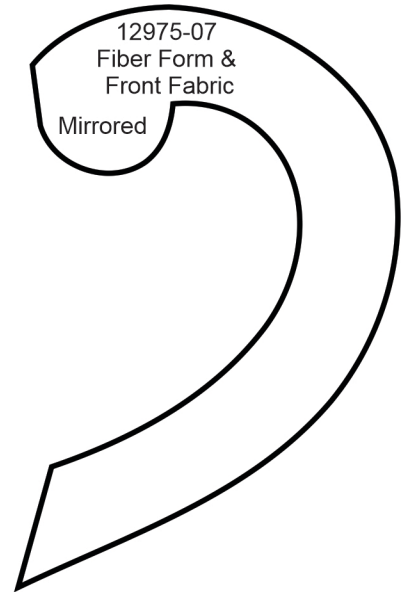

12975-07  
Fiber Form &  
Front Fabric  
Mirrored

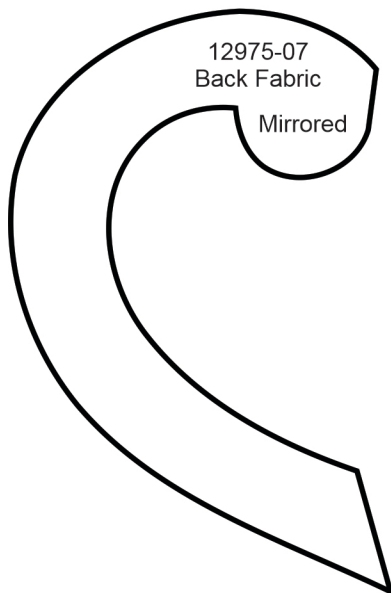

12975-07  
Back Fabric  
Mirrored

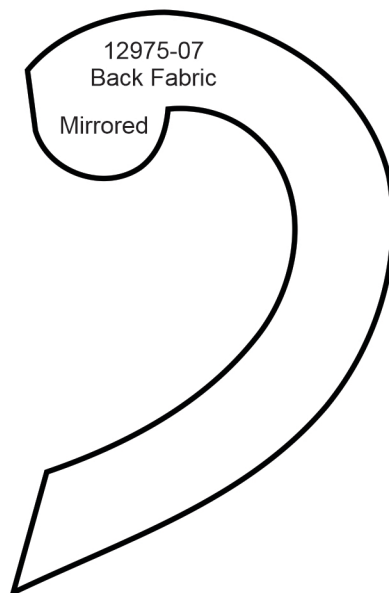

12975-07  
Back Fabric  
Mirrored

# MIRRORED PATTERNS



Print at 100%. No scaling. This box measures 1" x 1". Use the box as an accuracy guide when printing templates.

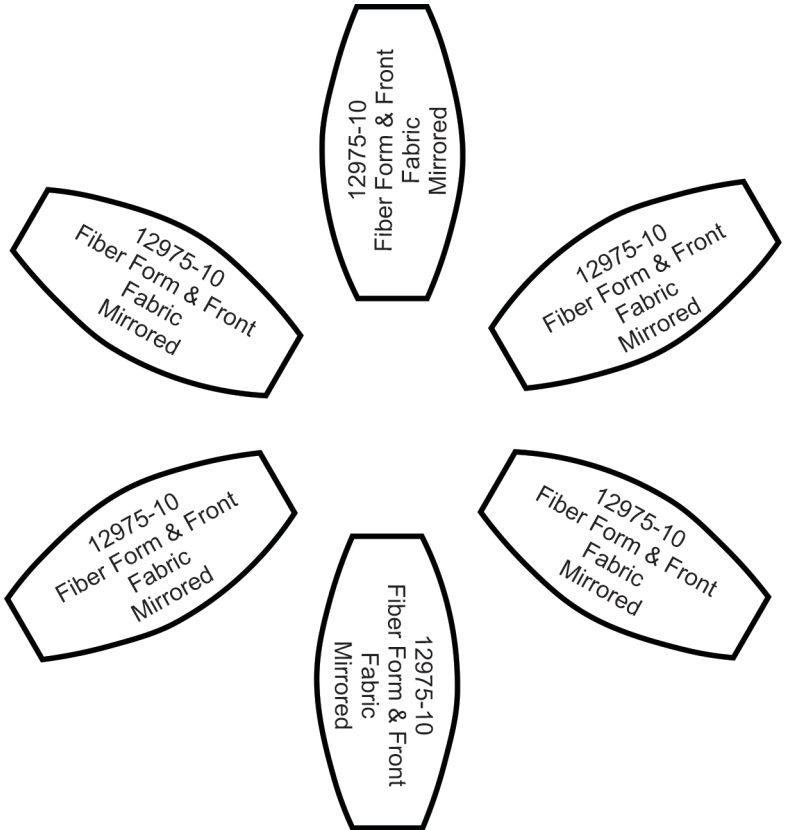
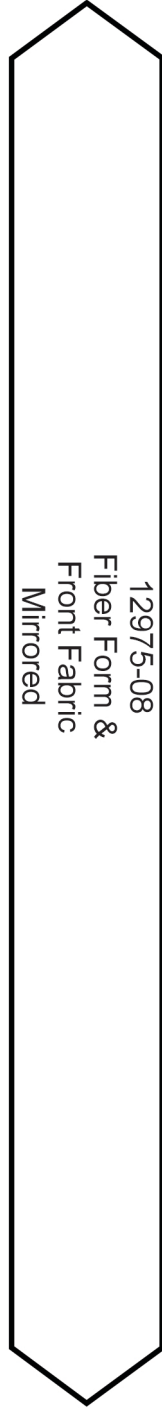
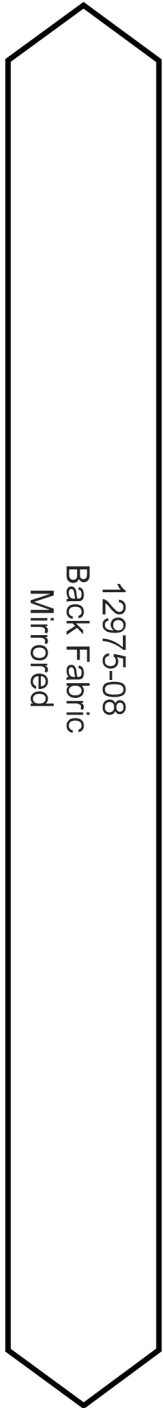

# MIRRORED PATTERNS PREMIER COLLECTION

Print at 100%. No scaling. This box measures 1" x 1". Use the box as an accuracy guide when printing templates.

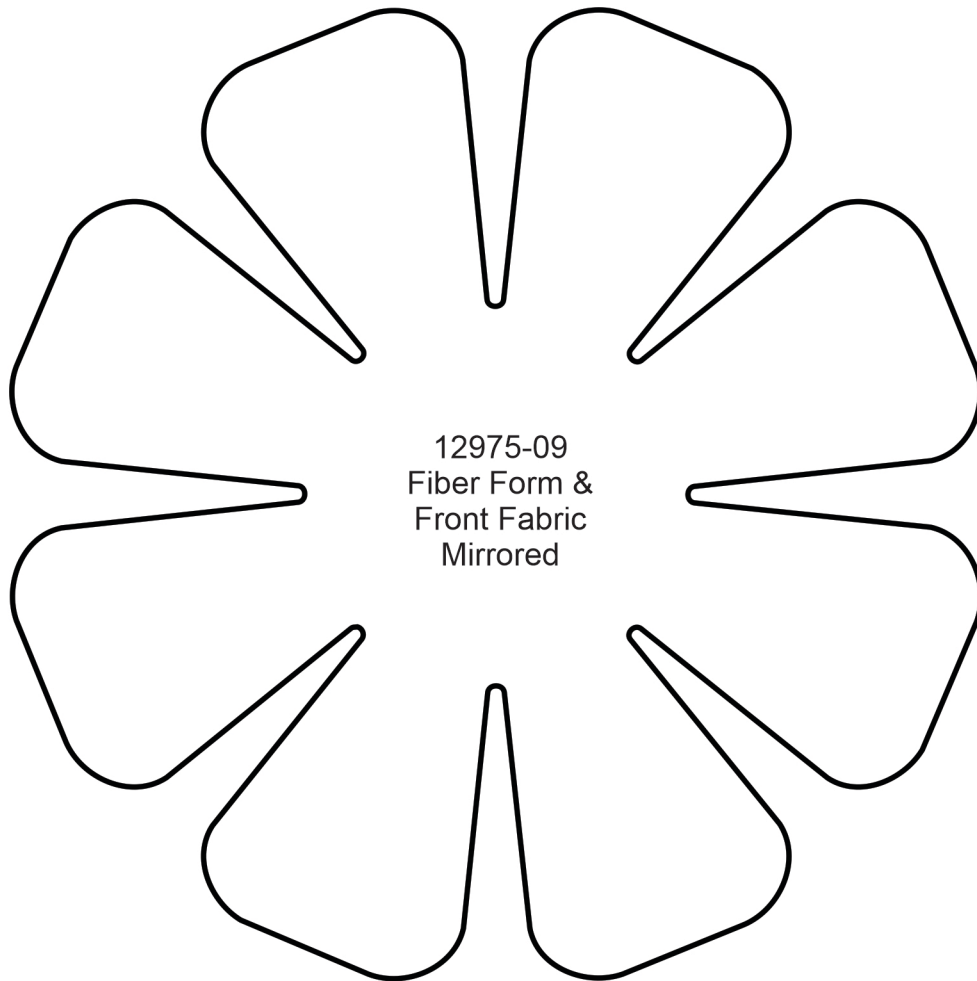

# MIRRORED PATTERNS PREMIER COLLECTION

Print at 100%. No scaling. This box measures 1" x 1". Use the box as an accuracy guide when printing templates.

